

# WINDOW INSTALLATION WITH **WEATHERSMART® DRAINABLE**

Due to the advanced drainage features of WeatherSmart Drainable, different installation methods are required. It is important to follow these instructions to ensure proper seal around windows and doors. This "Method A1" for

**WeatherSmart Drainable** installation guide is designed for integral flanged window applications, where the window is installed after the weather-resistive barrier (WRB) is applied. Compliance with the building code and proper installation are critical in reducing potential water leakage points. Consideration should be given to preparing the substrate, including cleaning the window flange and making sure the surfaces are dry and free of any debris. For best adhesion, an approved primer and J-roller are recommended.

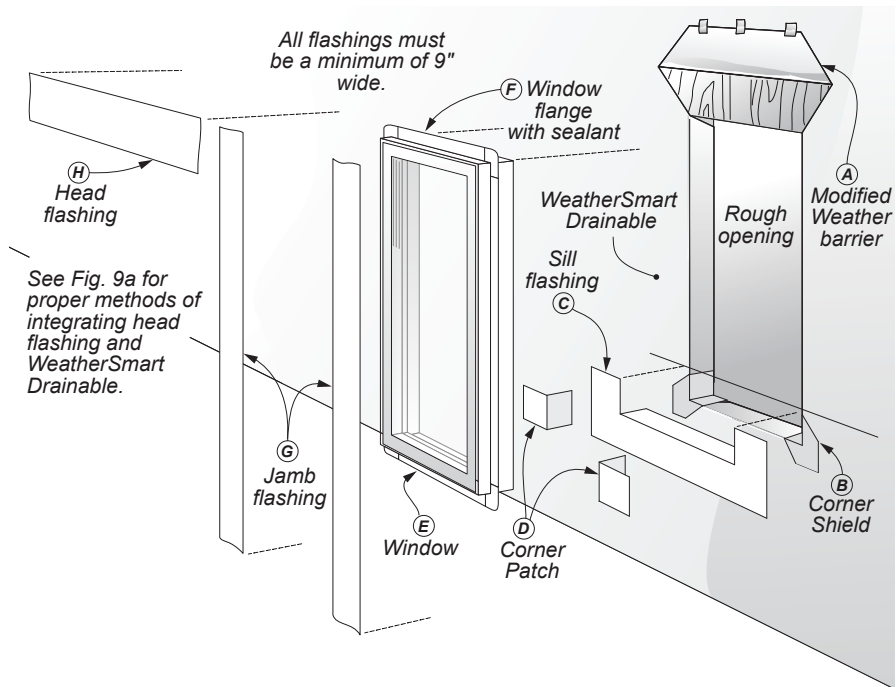

The following **Fortifiber Building Systems Group®** products are recommended for this method:

- FortiFlash® Flashing, FortiFlash® Commercial Flashing or FortiFlash® Butyl Flashing
- Moistop® Sealant and Liquid Flashing
- Moistop® Corner Shield
- Fortifiber® Primer
- WeatherSmart® Drainable

## 1 INSTALLING THE WRB

Install **WeatherSmart Drainable** over an approved exterior sheathing. Starting at the bottom of one end of the wall, place the **WeatherSmart Drainable** roll horizontally (overlapping the corner by a minimum of 12") and roll out the first course evenly, wrapping over the window and door rough openings. Place the membrane so that it is tight and flat.

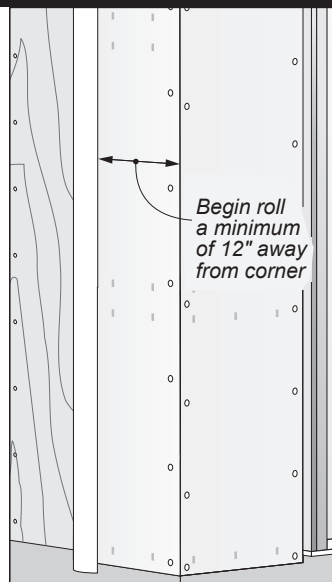

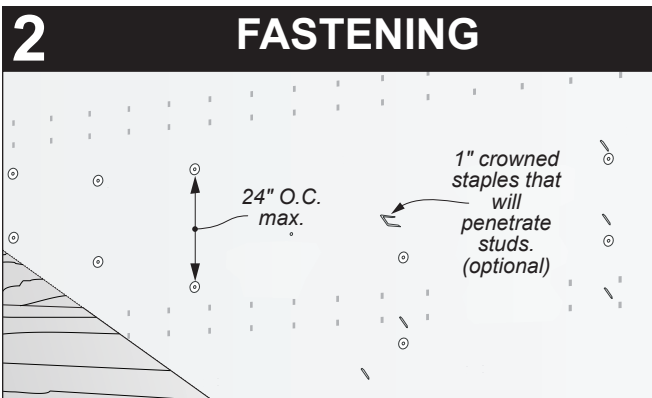

Fortifiber recommends using fasteners with 1" plastic caps, or using 1" crown staples that penetrate the studs to attach **WeatherSmart Drainable** so that it is taut and flat. The proper spacing for these fasteners is 24" on center, maximum. Closer spacing may be required based on site conditions.

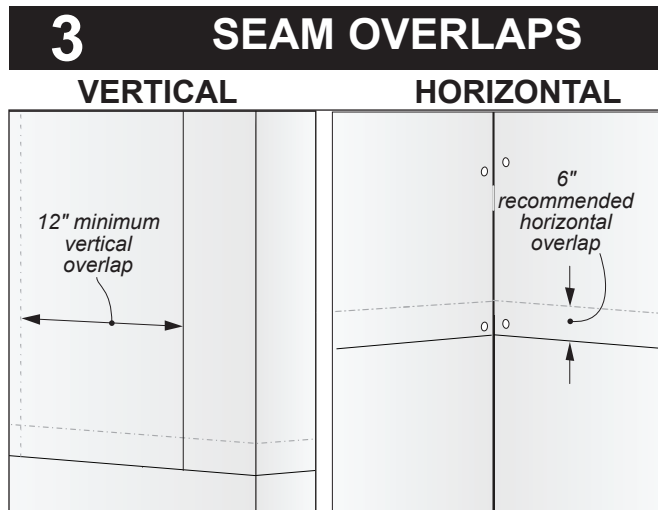

At vertical seams, apply a minimum 12" vertical overlap. When going around corners, make sure **WeatherSmart Drainable** is pulled tightly and properly fastened.

Any succeeding course should be placed horizontally over the lower course in a weather-board fashion with a minimum horizontal overlap of 6".

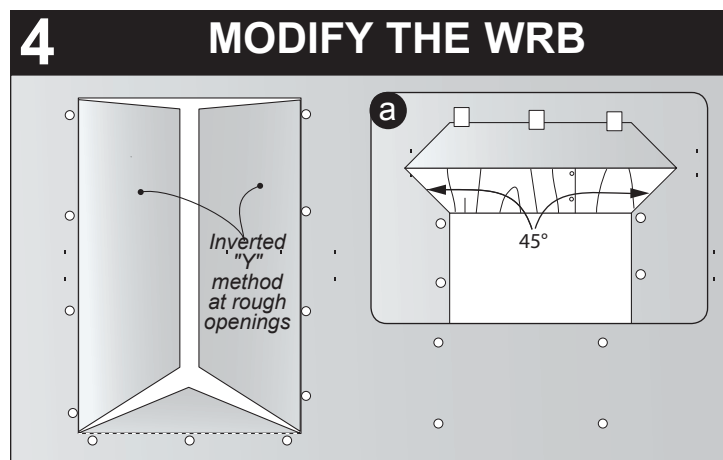

At the rough opening, cut the housewrap in an inverted "Y" fashion. Make diagonal cuts at the top of the rough opening corners. Example: for 9" flashing measure as follows: 9" up and 9" over, 45° angle (a). Cut on the diagonal from marked point to the rough opening corner. Raise the top edge of the **WeatherSmart Drainable** and tape the corners and the center to the surface above. This will allow for the installation of the window, the jamb and head flashing later.

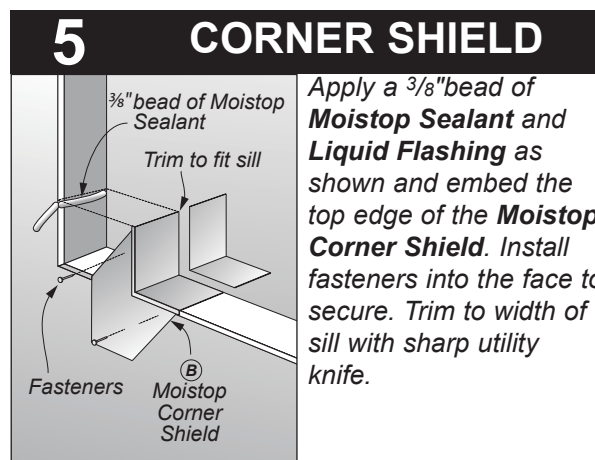

Apply a 3/8" bead of **Moistop Sealant** and **Liquid Flashing** as shown and embed the top edge of the **Moistop Corner Shield**. Install fasteners into the face to secure. Trim to width of sill with sharp utility knife.

6

## SILL FLASHING

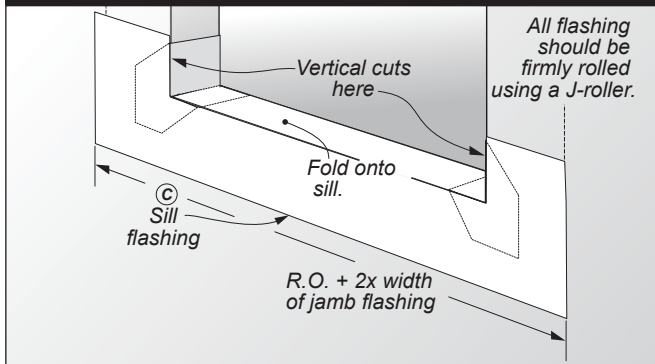

Cut the sill flashing to the width of the rough opening plus twice the jamb flashing width. ( R.O. + 2x width of jamb flashing). Remove the release paper and install the sill flashing in place. Make a vertical cut at each jamb and fold the flashing onto the sill. Once in place, all flashing should be firmly rolled using a J-roller.

7

## CORNER PATCHES

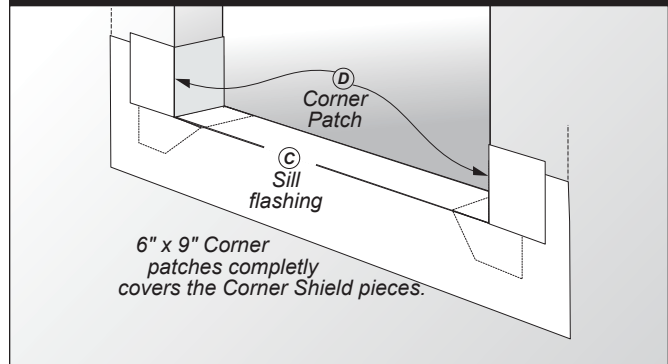

Cut two corner 6"x9" corner patches using 9" flashing. Install corner patches over each **Moistop Corner Shield** at the jambs.

8

## WINDOW INSTALLATION

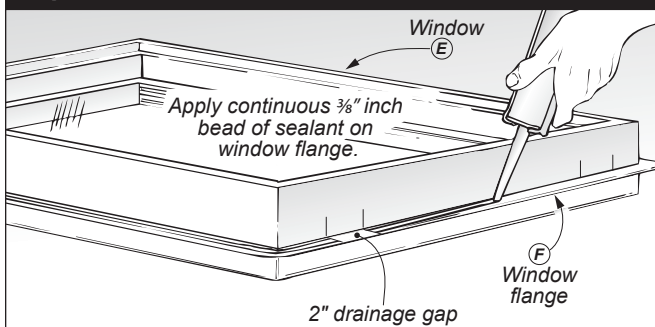

Before installing the window, apply a  $\frac{3}{8}$ " bead of **Moistop Sealant and Liquid Flashing** to the backside (interior) of the mounting flange leaving two 2" drainage gaps at the sill. Install the window according to the window manufacturer's instructions.

9

## JAMB FLASHING

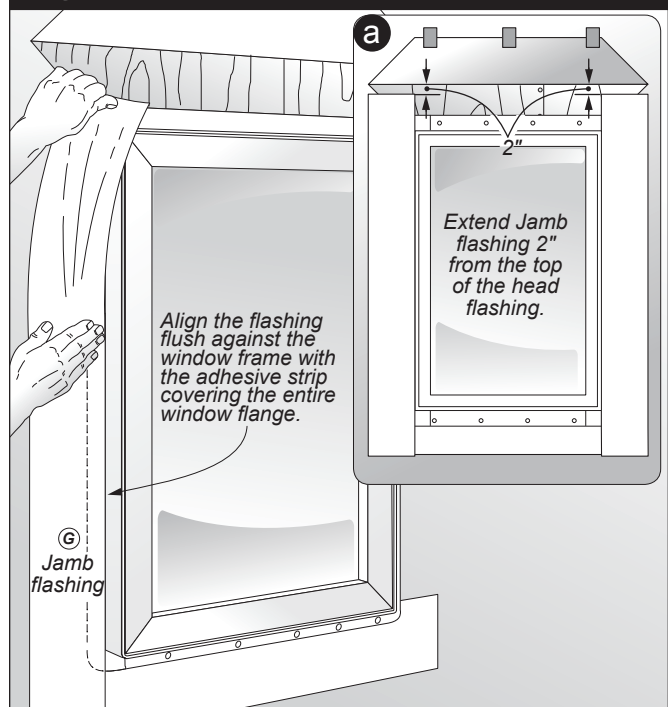

Prior to installing the jamb flashing wipe the jamb flange and **WeatherSmart Drainable** to ensure proper adhesion. Then cut two strips of flashing long enough to extend 1" beyond the sill flashing and 2" below the top of the head flashing. Remove the release paper and align the flashing flush against the window frame with the adhesive strip covering the entire window flange. Follow this procedure for the other side of the window.

# 10

## HEAD FLASHING

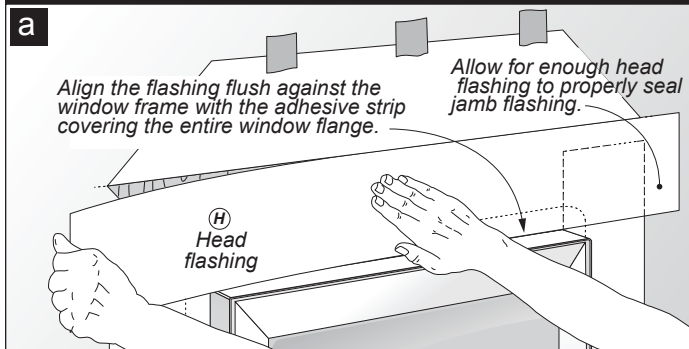

Wipe the head flange, and jamb flashing. Cut a piece of flashing long enough to ensure that the head flashing extends a minimum of 1" beyond the jamb flashing. Install the head flashing by pressing firmly in place in one direction to prevent voids. Once in place, all flashing should be firmly rolled using a J-roller.

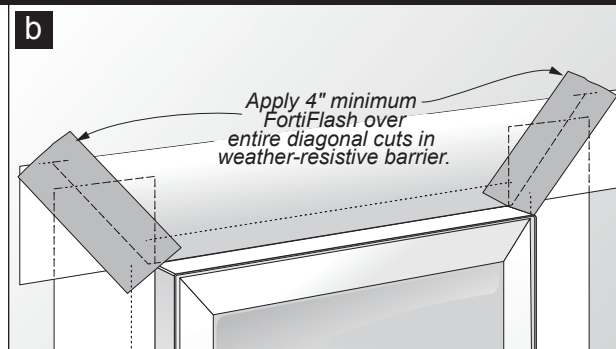

Finally, allow the flap of the weather-resistive barrier at the head to lay flat over the head flashing. Cut a piece of 9" flashing to make two diagonal patches and install over the entire diagonal cut made in the weather-resistive barrier and roll firmly in place.

# 11

## BACK DAM

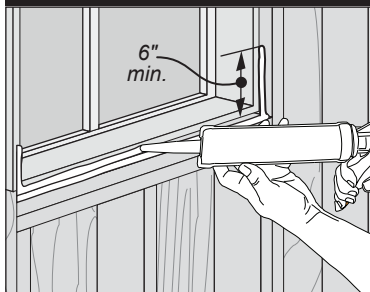

Provide a back dam and air seal to the inside of the rough opening. The configuration of the back dam will vary based on the profile of the window being installed.

## OVERVIEW

This recommendation refers to the most commonly used types of windows (surface mounted). For other types of frames, special attention should be paid to the window manufacturer's instructions.

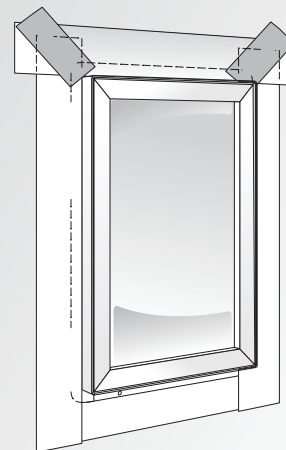

## WEATHERSMART DRAINABLE AND WINDOWS

Windows, window flashings and weather barriers must be properly integrated in order to form a comprehensive moisture control system. The windows shown in this guide follow the Method "A1" window installation and reference the **AMERICAN ARCHITECTURAL MANUFACTURERS ASSOCIATION**.

Also, you can find other detailed instructions on how to integrate weather barriers and window flashings at [www.fortifiber.com](http://www.fortifiber.com)

**Limitations: WeatherSmart Drainable** should be covered within 120 days. Inspect product to ensure it is free of any protrusions or damage which may detract from the weather resistive barrier integrity. Holes, tears or punctures should be sealed with **Moistop Sealant** or **Fortifiber Sheathing Tape**. This product is not recommended for horizontal, roofing or below grade applications. Ensure that a layer of **Super Jumbo Tex 60 Minute** is used to separate **WeatherSmart Drainable** and Portland cement stucco or mortar used in masonry veneer walls.



**Fortifiber Building Systems Group®**

*Protecting Your World from the Elements™*

NATIONAL SALES OFFICE Reno, NV (7/26/16)