

BLUESKIN PRESEAL TAPE 50S DOUBLE SIDED TAPE INSTALLATION GUIDELINES

1. REMOVE PLASTIC RELEASE LINER ON ONE SIDE OF **BLUESKIN PRESEAL TAPE 50S** DOUBLE SIDED TAPE AND ADHERE TO PRE-APPLIED WATERPROOFING EDGE.
2. FIRMLY PRESS TAPE INTO PLACE.
3. ROLL TAPE WITH STEEL ROLLER TO ENSURE CONTINUOUS ADHESION.
4. REMOVE REMAINING PLASTIC RELEASE LINER ON TAPE.
5. OVERLAP SUBSEQUENT WATERPROOFING MEMBRANE AT SEAM.
6. FIRMLY PRESS MEMBRANE SEAM INTO PLACE.
7. ROLL MEMBRANE SEAM WITH STEEL ROLLER TO ENSURE CONTINUOUS ADHESION.

BLUESKIN PRESEAL TAPE 50S - DOUBLE SIDED TAPE
NO SELVEDGE AT PRE-APPLIED WATERPROOFING SEAM

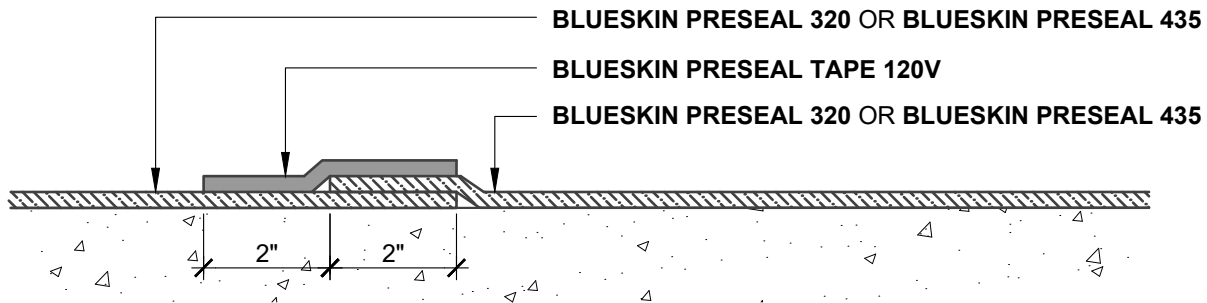

BLUESKIN PRESEAL TAPE 120V TAPE INSTALLATION GUIDELINES

1. REMOVE PLASTIC RELEASE LINER OF **BLUESKIN PRESEAL TAPE 120V**.
2. ADHERE TAPE TO PRE-APPLIED WATERPROOFING OVERLAP SEAM.
3. FIRMLY PRESS TAPE INTO PLACE.
4. ROLL TAPE WITH STEEL ROLLER TO ENSURE CONTINUOUS ADHESION.

BLUESKIN PRESEAL TAPE 120V - DETAIL STRIP WITH TAPE
NO SELVEDGE AT PRE-APPLIED WATERPROOFING SEAM

NOTES:

1. DETAIL SHOWS HENRY PRE-APPLIED WATERPROOFING SYSTEM FOR APPLICATIONS USING HENRY **BLUESKIN PRESEAL 320** OR **BLUESKIN PRESEAL 435**. SUBSTRATE SHOWN IS FOR REFERENCE ONLY.
2. REFER TO PRODUCT SPECIFIC TECHNICAL DATA SHEET (TDS) AND GUIDE SPECIFICATION FOR INSTALLATION PROCEDURES.

Henry[®]

999 N. Pacific Coast Highway, Suite 800
El Segundo, CA 90245
800-486-1278 • www.henry.com

MANUFACTURER GUIDE DETAILS ARE FOR REFERENCE ONLY. HENRY DOES NOT ASSUME RESPONSIBILITY FOR ERRORS OR DEVIATIONS IN DESIGN OR ENGINEERING. PROJECT SPECIFIC VERIFICATION IS RECOMMENDED PRIOR TO INSTALLATION.

HENRY PRE-APPLIED WATERPROOFING SYSTEM

MEMBRANE SEAM OVERLAP
BLUESKIN PRESEAL 320 OR BLUESKIN PRESEAL 435
TAPE AT WATERPROOFING MEMBRANE SEAMS

SCALE: N.T.S.

11-20-2020

BSPS-3B