

BLUESKIN PRESEAL TAPE 120V
 (EXTEND 1" (25MM) MINIMUM
 BEYOND WATERPROOFING
 TERMINATION SEALANT)

SET PRE-APPLIED
 WATERPROOFING
 INTO WET **HENRY**
925 BES SEALANT
 AND TERMINATE WITH
HENRY 925 BES SEALANT

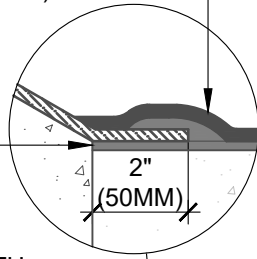

COLUMN

HENRY 925 BES SEALANT
 (EXTEND 1" (25MM) ONTO REBAR)

BLUESKIN PRESEAL TAPE 120V
 (EXTEND 1" MINIMUM BEYOND
 WATERPROOFING TERMINATION
 SEALANT)

BLUESKIN PRESEAL 30
 OR **BLUESKIN PRESEAL 435**

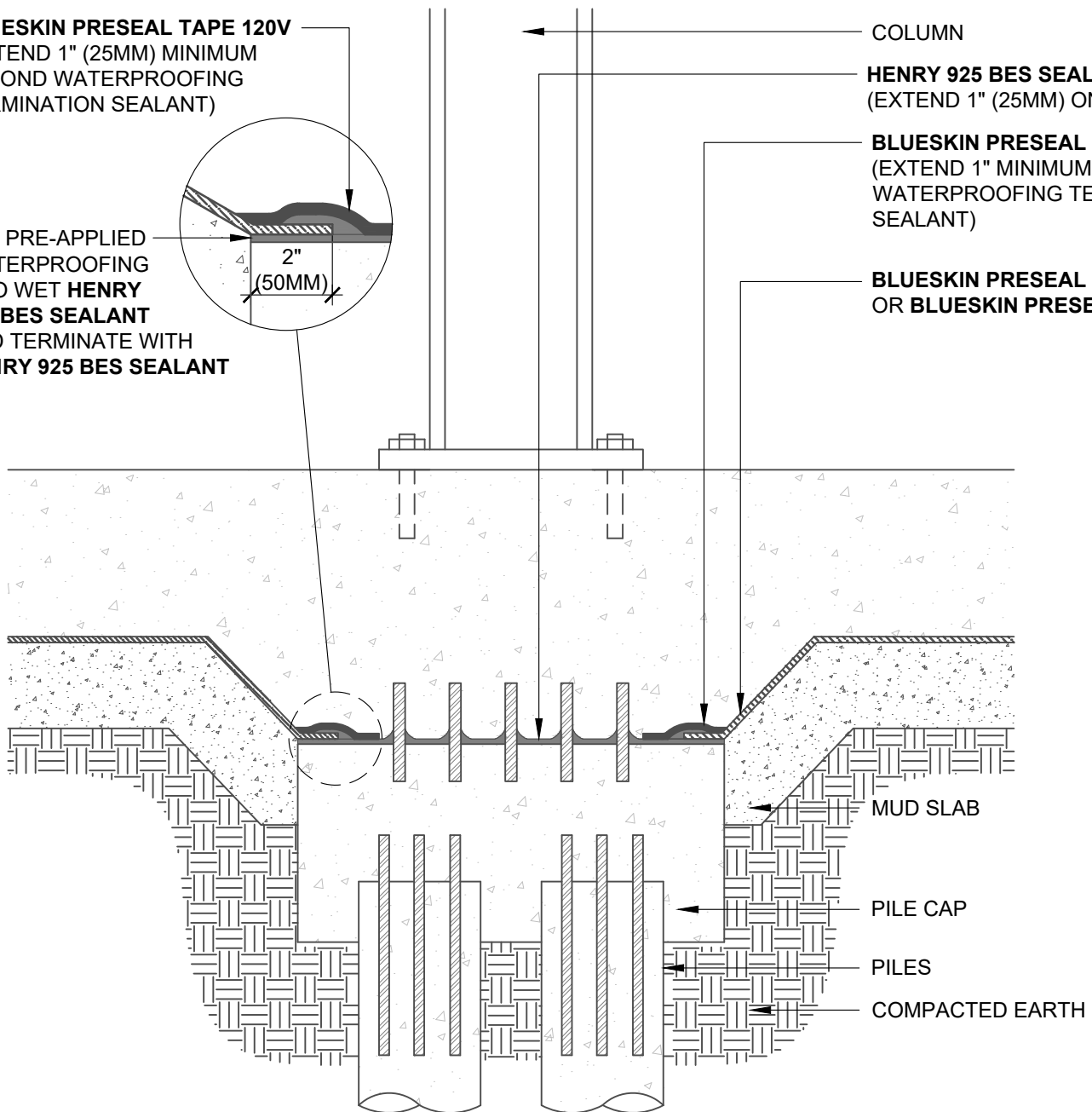

NOTES:

1. DETAIL SHOWS HENRY PRE-APPLIED WATERPROOFING SYSTEM FOR APPLICATIONS USING HENRY **BLUESKIN PRESEAL 30** OR **BLUESKIN PRESEAL 435**. SUBSTRATE SHOWN IS FOR REFERENCE ONLY.
2. SEE DETAIL BSPS-4A5B WHERE PRE-APPLIED WATERPROOFING IS INSTALLED OVER COMPACTED EARTH.
3. REFER TO PRODUCT SPECIFIC TECHNICAL DATA SHEET AND GUIDE SPECIFICATION FOR INSTALLATION PROCEDURES.

MANUFACTURER GUIDE DETAILS ARE FOR REFERENCE ONLY. HENRY DOES NOT ASSUME RESPONSIBILITY FOR ERRORS OR DEVIATIONS IN DESIGN OR ENGINEERING. PROJECT SPECIFIC VERIFICATION IS RECOMMENDED PRIOR TO INSTALLATION.

HENRY PRE-APPLIED WATERPROOFING SYSTEM

GRADE BEAM

BLUESKIN PRESEAL 320 OR BLUESKIN PRESEAL 435
MUD SLAB

SCALE: N.T.S.

11-06-2023

BSPS-4A.5B

