

BLUESKIN® VP160

EXTEND FLASHING 3" MIN
ONTO EXTERIOR SHEATHING

METAL HEAD FLASHING
(TYPICAL)

**BLUESKIN® BUTYL FLASH,
BLUESKIN® SA,
BLUESKIN® SALT OR
METAL CLAD®**

EXTEND FLASHING 3" MIN
ONTO EXTERIOR SHEATHING

212 SEALANT
(TROWEL SEALANT UNTIL
MEMBRANE EDGE IS FULLY
COATED TO PROMOTE WATER
SHEDDING)

BLUESKIN® VP160

**BLUESKIN® BUTYL FLASH,
BLUESKIN® SA,
BLUESKIN® SALT OR
METAL CLAD®**

EXTEND FLASHING
3" RECOMMENDED
(2" MIN) INTO
ROUGH OPENING

EXTEND FLASHING 3" MIN
ONTO EXTERIOR SHEATHING

BLUESKIN® VP160

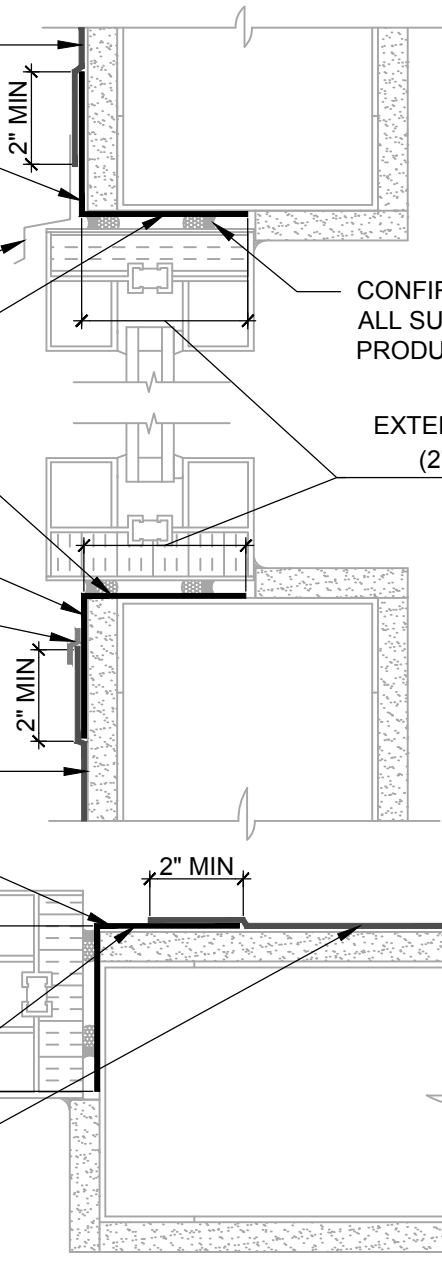

HEAD

CONFIRM SEALANT COMPATIBILITY WITH
ALL SUBSTRATES AND ADJACENT
PRODUCTS PRIOR TO INSTALLATION

EXTEND FLASHING 3" RECOMMENDED
(2" MIN) INTO ROUGH OPENING

SILL

JAMB

NOTES:

1. DETAIL SHOWS **BLUESKIN® VP160** ASSEMBLY INSTALLED OVER EXTERIOR GRADE SHEATHING. ACCEPTABLE SUBSTRATES INCLUDE PLYWOOD, OSB, CONCRETE, GYPSUM BOARD AND CONCRETE BLOCK.
2. INSTALL FLASHING AT SILL PAN EXTENDING 6" MINIMUM UP JAMB.
3. WINDOW FLASHING RECOMMENDATIONS ARE BASED OFF ASTM E2112 AND MAY VARY DEPENDING ON PROJECT SPECIFIC REQUIREMENTS. WINDOW INSTALLATION REQUIREMENTS TO BE VERIFIED BY DESIGN PROFESSIONAL.
4. PRIME **BLUESKIN® VP160** WHERE **BLUESKIN® SA, BLUESKIN® SALT OR METAL CLAD®** LAP ONTO **BLUESKIN® VP160**. RECOMMENDED PRIMERS/ADHESIVES INCLUDE: **BLUESKIN® LVC ADHESIVE, AQUATAC™ PRIMER OR BLUESKIN® ADHESIVE.**
5. INSULATION, CLADDING AND OPTIONAL VAPOR BARRIER NOT SHOWN FOR CLARITY.
6. REFER TO **BLUESKIN® VP160** INSTALLATION MANUAL FOR RECOMMENDED INSTALLATION PROCEDURES.

Henry®

999 Sepulveda Blvd., Suite 800
El Segundo, CA 90245
800-486-1278 • www.henry.com

MANUFACTURER GUIDE DETAILS ARE FOR REFERENCE ONLY. HENRY® DOES NOT ASSUME RESPONSIBILITY FOR ERRORS OR DEVIATIONS IN DESIGN OR ENGINEERING. PROJECT SPECIFIC VERIFICATION IS RECOMMENDED PRIOR TO INSTALLATION.

BLUESKIN® VP160 SELF-ADHERED WATER RESISTIVE AIR BARRIER

REBATE WINDOW

METHOD A - **BLUESKIN® VP160** INSTALLED AFTER
SELF-ADHERED FLASHING

SCALE: N.T.S.

06-20-2017

BSVP160-6A1A