

BLUESKIN® VP160 FLANGED WINDOW DETAIL GUIDELINES CONSISTS OF THREE PARTS.
 REFER TO DETAIL BSVP160-6C1A FOR PREVIOUS STEPS 1-2
 AND DETAIL BSVP160-6C1C FOR STEPS 5-8.

STEP 2 (CONTINUED)

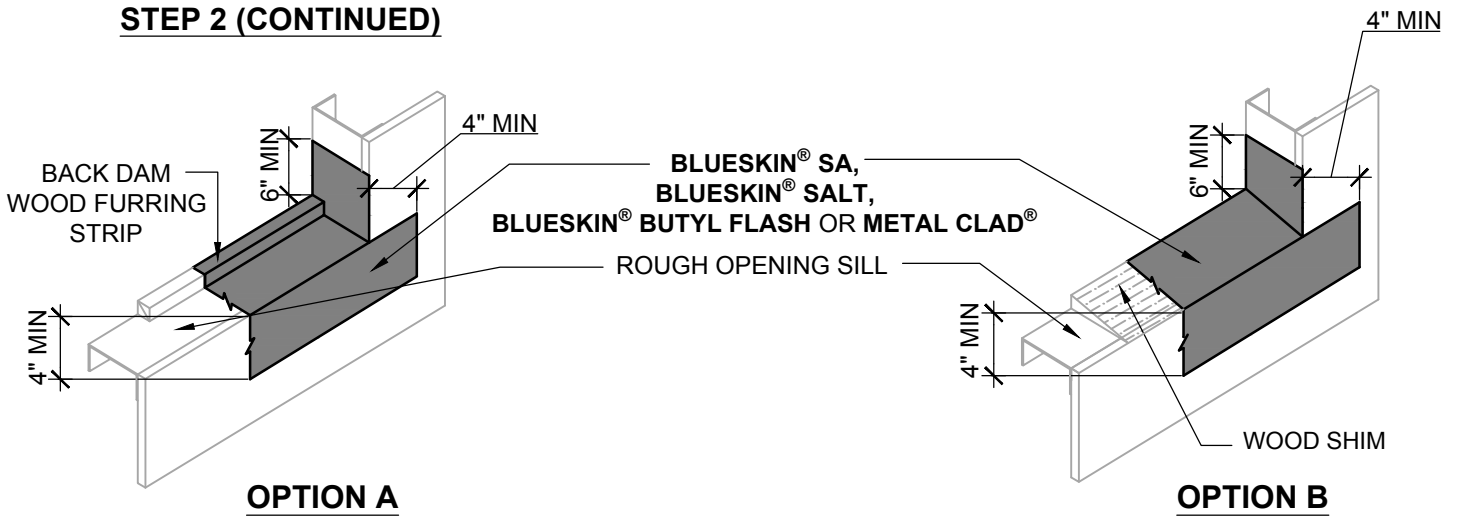

STEP 3

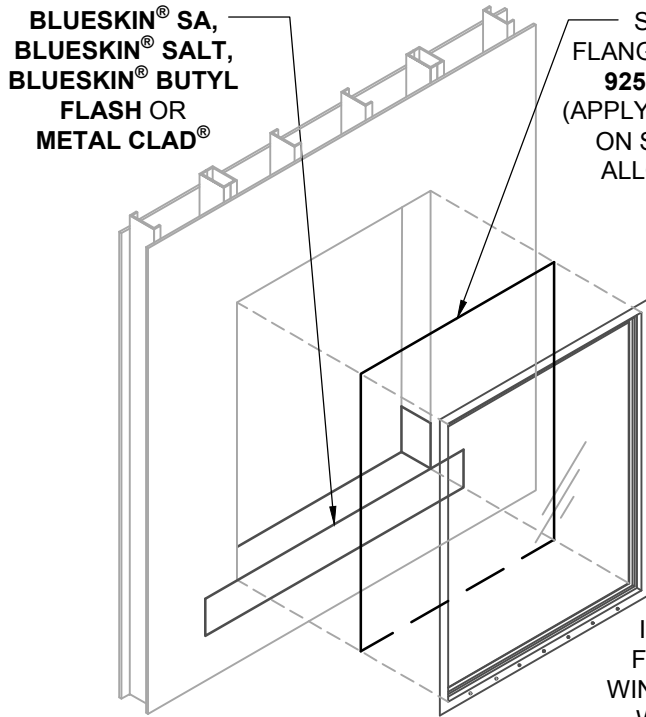

STEP 4

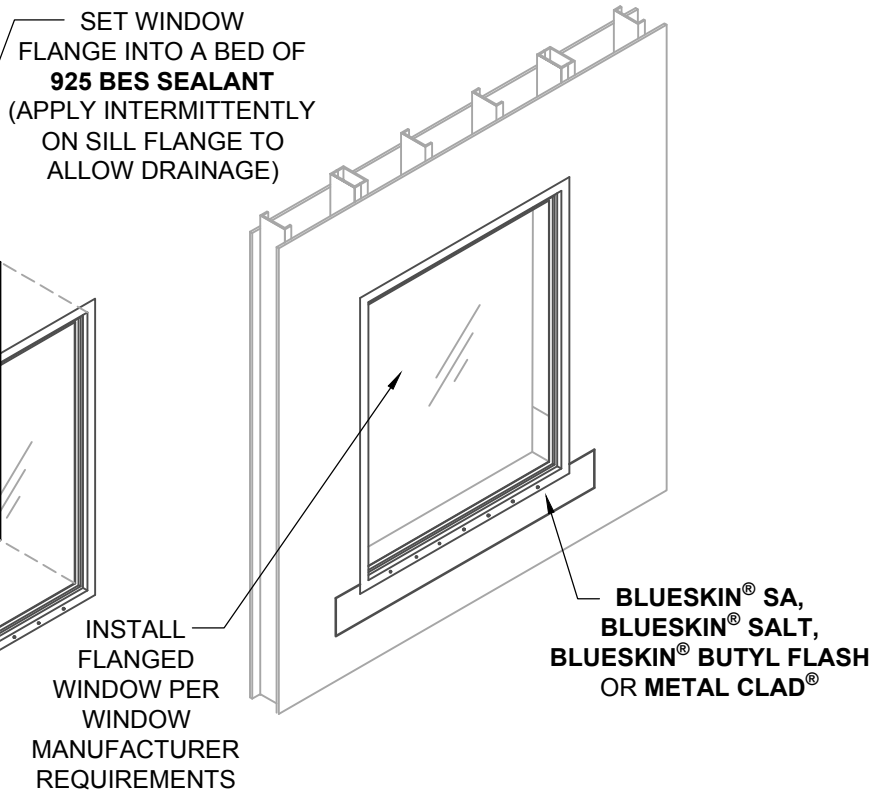

NOTES:

1. REFER TO NOTES BSVP160-6C1A.

MANUFACTURER GUIDE DETAILS ARE FOR REFERENCE ONLY. HENRY® DOES NOT ASSUME RESPONSIBILITY FOR ERRORS OR DEVIATIONS IN DESIGN OR ENGINEERING. PROJECT SPECIFIC VERIFICATION IS RECOMMENDED PRIOR TO INSTALLATION.

BLUESKIN® VP160 SELF-ADHERED WATER RESISTIVE AIR BARRIER

FLANGED WINDOW

METHOD A - **BLUESKIN® VP160** INSTALLED AFTER
 SELF-ADHERED FLASHING PART 2 OF 3

SCALE: N.T.S. 06-20-2017

BSVP160-6C1B



999 Sepulveda Blvd., Suite 800
 El Segundo, CA 90245
 800-486-1278 • www.henry.com