

1. Deck
2. Primer
3. Blueskin WP 200 Membrane
4. Insulation
5. Drainage Composite
6. Pavers

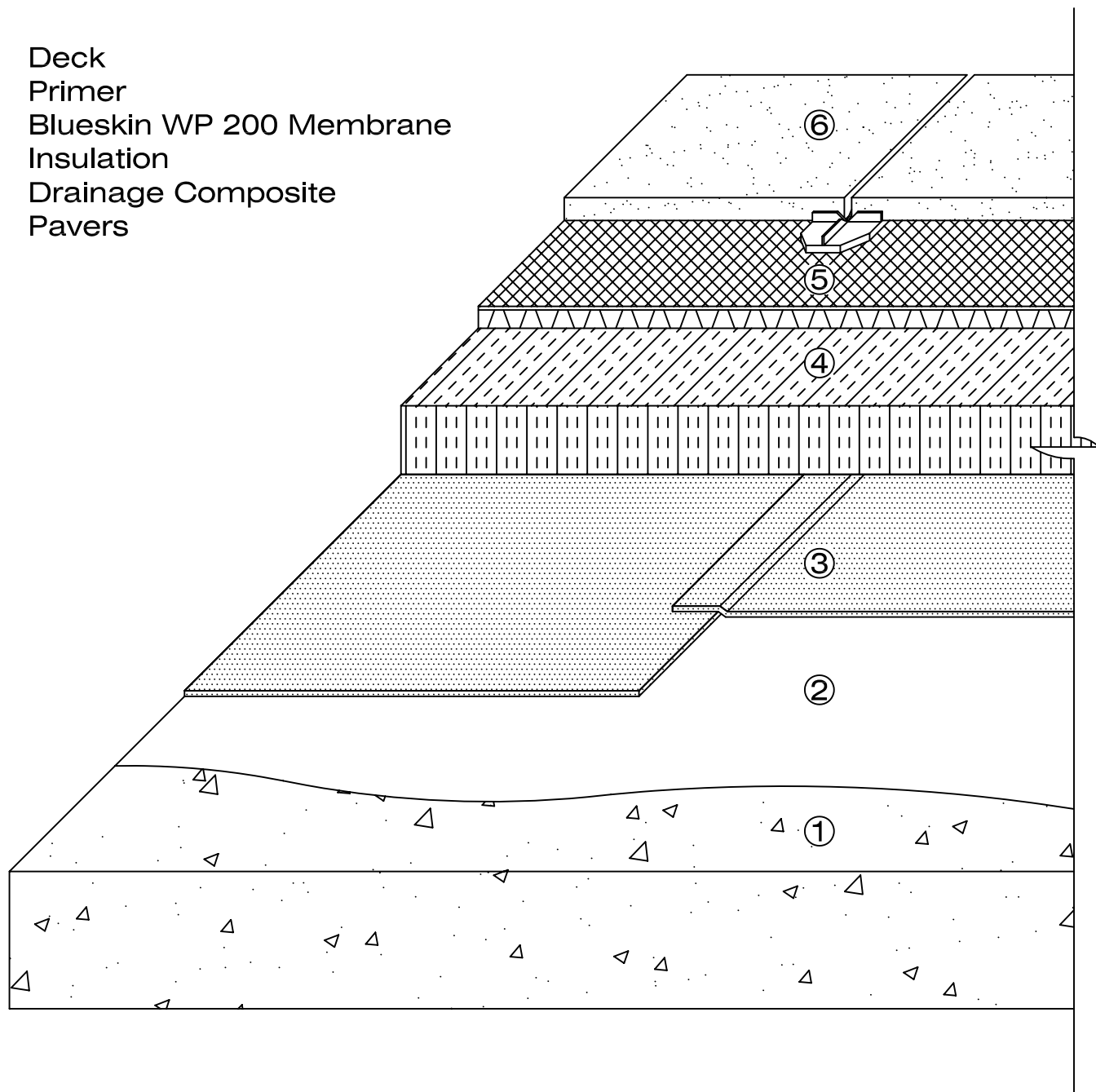

Notes:

1. System detail showing typical application to an insulated concrete plaza deck.
2. Application of the blueskin WP 200 membrane begins in the drain and proceeds toward the high point in a shingle fashion.
3. Other horizontal applications include planters, indoor mechanical rooms, laboratories and bathrooms.
4. Drainage may be facilitated by using drainage type insulation. On non-insulated assemblies, a drainage composite may be used.

Henry
COMPANY®

BLUESKIN WP-200

SCALE: N.T.S.

CONCRETE PLAZA DECK APPLICATIONS

**SYSTEM
DETAIL**

ES-H102