

1. Deck
2. Primer: Henry 930-18 or 910-01
3. modifiedPLUS NP180gT4
4. 790-11 Membrane (90 mil base coat)
5. Polyfab Reinforcement
6. 790-11 Membrane (125 mil top coat)
7. Separation Layer: G 100 s/s or Protection Board
8. Extruded Polysterene Insulation
9. Filter Fabric: Henry NO3 or NO4
10. Pavers or Stone Ballast
11. Metal Flashing

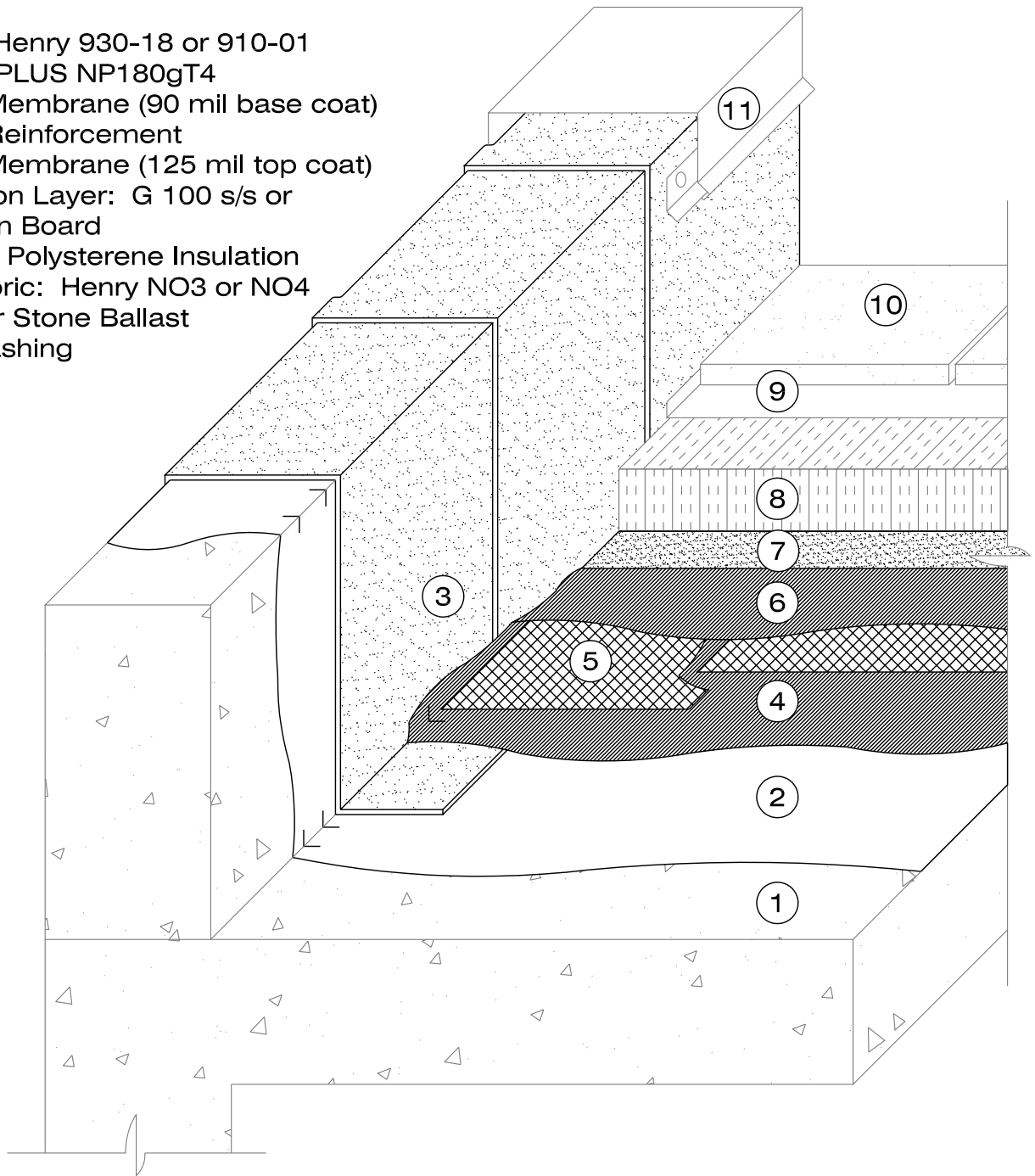

Notes:

1. System detail showing modifiedPLUS NP180gT4 modified bitumen sheet as the flashing membrane. The NP180gT4 is thermofused to the substrate prior to application of the 790-11 hot applied rubberized asphalt.
2. Drainage layers are optional on all 790-11 details and should be positioned above the insulation layer.
3. The modifiedPLUS NP180gT4 membrane has a ceramic granule surface which is designed to be an exposed finished surface.

Henry
COMPANY®

790-11 MEMBRANE P.M.R. ASSEMBLY

SCALE: N.T.S.

CONCRETE DECK - PARAPET

FIT TO PAPER

**THERMOFUSED
SBS SYS. DETAIL**

HR-H103