

**GAPS UP TO 2" MAX (PLAN VIEW)**  
FLASHING INSTALLED BEFORE WRB

**BLUESKIN METAL CLAD**  
LAP AIR BARRIER 2" ONTO FLASHING

**BLUESKIN METAL CLAD**  
(SEE CONVEX LOOP FLASHING DETAIL)

CREATE CONVEX LOOP IN MEMBRANE OVER BACKER ROD. PRIOR TO INSTALLATION, ADHERE MEMBRANE TO ITSELF AND INSTALL TO PREVENT ADHESION TO BACKER ROD.

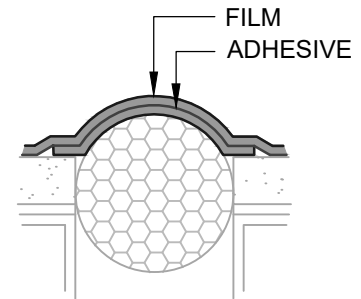

**CONVEX LOOP FLASHING**  
"SIAMESE" FLASHING

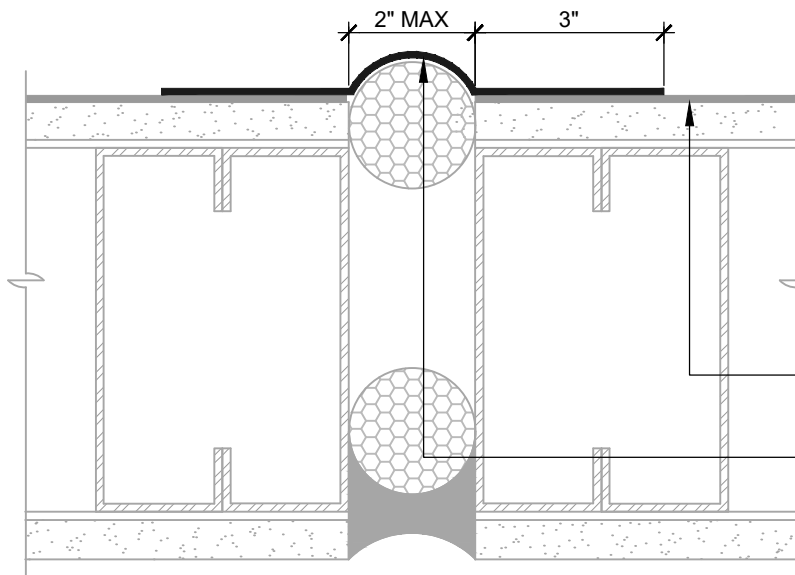

**GAPS UP TO 2" MAX (PLAN VIEW)**  
FLASHING INSTALLED AFTER WRB

**BLUESKIN METAL CLAD**

**BLUESKIN METAL CLAD**  
(SEE CONVEX LOOP FLASHING DETAIL)

**NOTES:**

1. DETAIL SHOWS **BLUESKIN METAL CLAD SELF-ADHERED WATER RESISTIVE AIR BARRIER**. SUBSTRATE SHOWN IS FOR REFERENCE ONLY. ACCEPTABLE SUBSTRATES INCLUDE PLYWOOD, OSB, CONCRETE, CMU, METAL, AND EXTERIOR GRADE SHEATHING.
2. SELF-ADHERED MEMBRANE PRIMER NOT SHOWN FOR CLARITY.
3. OTHER FLASHING OPTIONS INCLUDE: **BLUESKIN BUTYL FLASH**, **BLUESKIN SA** OR **BLUESKIN SA LT**.
4. INSTALL **BLUESKIN METAL CLAD** TO ACHIEVE A CONTINUOUS WATER-RESISTIVE BARRIER (WRB). INSULATION AND CLADDING NOT SHOWN FOR CLARITY.
5. REFER TO PRODUCT SPECIFIC TECHNICAL DATA SHEET (TDS) AND **BLUESKIN METAL CLAD** GUIDE SPECIFICATION FOR INSTALLATION PROCEDURES.

MANUFACTURER GUIDE DETAILS ARE FOR REFERENCE ONLY. HENRY DOES NOT ASSUME RESPONSIBILITY FOR ERRORS OR DEVIATIONS IN DESIGN OR ENGINEERING. PROJECT SPECIFIC VERIFICATION IS RECOMMENDED PRIOR TO INSTALLATION.

**BLUESKIN METAL CLAD SELF-ADHERED AIR BARRIER**

**NON-MOVING JOINTS**

**SUBSTRATE GAPS UP TO 2" WIDE MAXIMUM**  
**SELF-ADHERED FLASHING**

SCALE: N.T.S.

01-09-2020

**MTLCLD-8C**

**Henry**<sup>®</sup>

999 N. Pacific Coast Highway, Suite 800  
El Segundo, CA 90245  
800-486-1278 • www.henry.com