

- OPTIONAL WEAR COAT
- **HENRY GP WEARCOAT** (26 MILS)
 - DRY SILICA SAND (SEE NOTE #2)
- HENRY PRODEQ FX 400** (100 MILS)
HENRY ST PRIMER WITH AGGREGATE

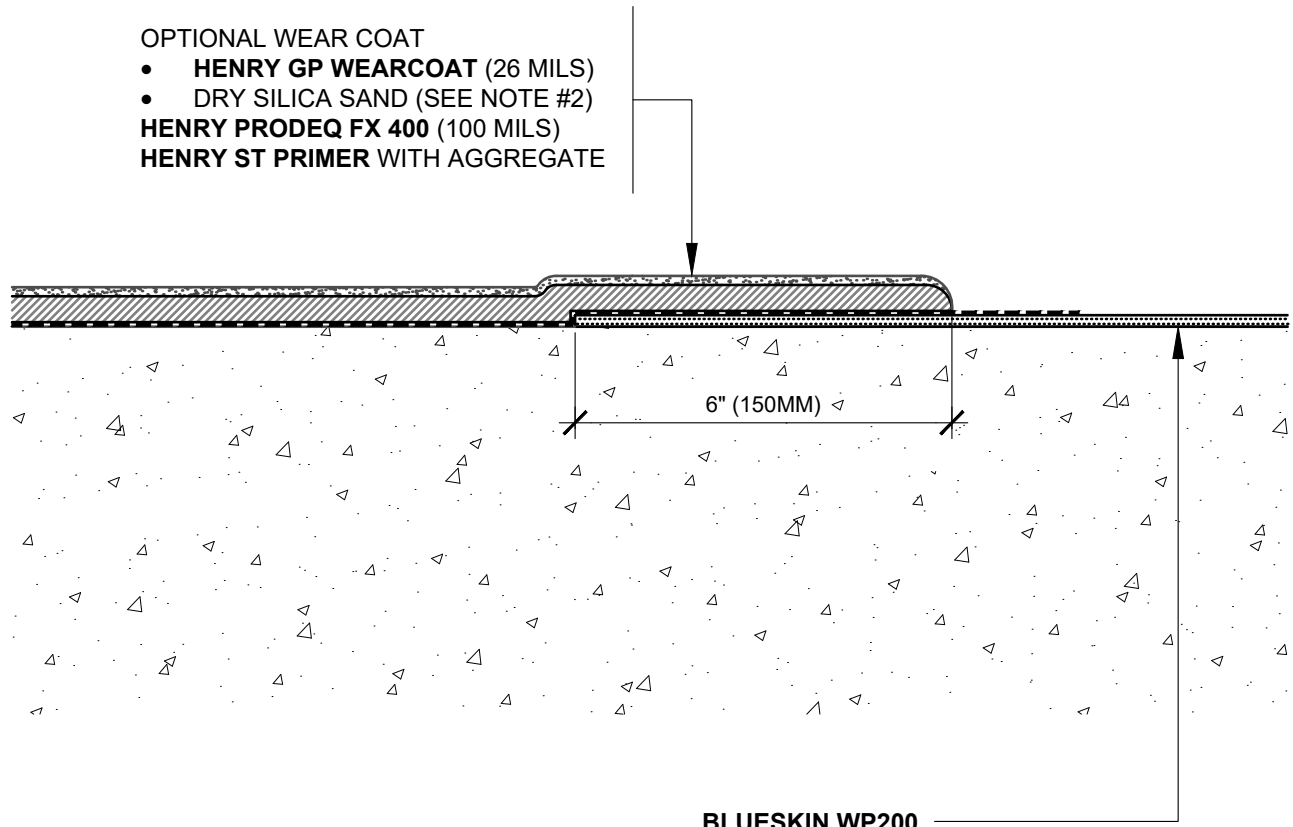

BLUESKIN WP200
 PRIMER NOT SHOWN FOR CLARITY
 (SEE NOTE #4)

NOTES:

1. DETAIL SHOWS HENRY **PRODEQ SYSTEM** TRANSITION WITH **BLUESKIN WP200**. SUBSTRATE SHOWN IS FOR REFERENCE ONLY. REFER TO PRODUCT SPECIFIC TECHNICAL DATA SHEET FOR AUTHORIZED SUBSTRATES.
2. FULLY BROADCAST, TO REJECTION, DRY SILICA SAND (SIEVE SIZE: #20-30) INTO WET **HENRY ST PRIMER**.
3. THE STANDARD PRIMER FOR THE HENRY **PRODEQ SYSTEM** IS **HENRY ST PRIMER WITH AGGREGATE**. REFER TO PRODUCT SPECIFIC DATA SHEET FOR PRODUCT SPECIFIC INFORMATION.
4. REFER TO THE **BLUESKIN WP200** TECHNICAL DATA SHEET FOR PRIMER RECOMMENDATIONS.
5. PREPARE AND PRIME VERTICAL SUBSTRATES A MINIMUM 2" BEYOND **PUMADEQ SYSTEM** APPLICATION IN ACCORDANCE WITH HENRY **PUMADEQ SYSTEM** SUBSTRATE PREPARATION GUIDELINES.
6. DO NOT INSTALL **PRODEQ SYSTEM** BEYOND PRIMED SURFACES.
7. REFER TO PRODUCT SPECIFIC GUIDE SPECIFICATION FOR RECOMMENDED INSTALLATION PROCEDURES.



999 N. Pacific Coast Highway, Suite 800
 El Segundo, CA 90245
 800-486-1278 • www.henry.com

MANUFACTURER GUIDE DETAILS ARE FOR REFERENCE ONLY. HENRY DOES NOT ASSUME RESPONSIBILITY FOR ERRORS OR DEVIATIONS IN DESIGN OR ENGINEERING. PROJECT SPECIFIC VERIFICATION IS RECOMMENDED PRIOR TO INSTALLATION.

PRODEQ SYSTEM TIE-IN TO BLUESKIN WP200

TIE-IN DETAIL

**PRODEQ SYSTEM AND BLUESKIN WP200
 DISSIMILAR MATERIAL TRANSITION**

SCALE: N.T.S.

03-02-2022

PRDQ-TID-B1A