

FILL BUG HOLES/VOIDS WITH  
CONCRETE REPAIR  
MORTAR/GROUT AND ALLOW TO  
FULLY CURE PRIOR TO  
MEMBRANE APPLICATION

**HENRY PRODEQ FX 400** (100 MILS)

PRIMER (SEE NOTE #2)

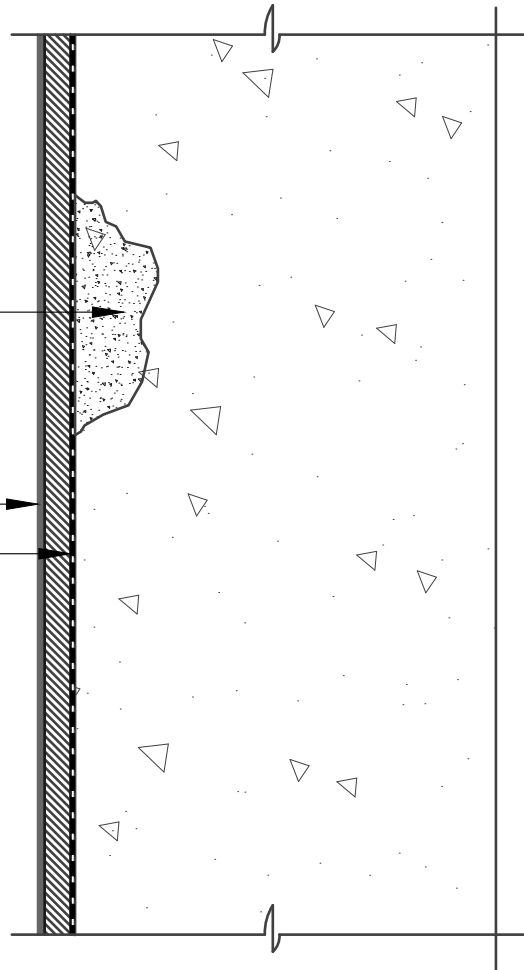

**NOTES:**

1. DETAIL SHOWS HENRY **PRODEQ** SYSTEM WATERPROOFING ASSEMBLY. SUBSTRATE SHOWN IS FOR REFERENCE ONLY. REFER TO PRODUCT SPECIFIC TECHNICAL DATA SHEET FOR AUTHORIZED SUBSTRATES.
2. THE STANDARD PRIMER FOR THE HENRY **PRODEQ** SYSTEM IS **HENRY ST PRIMER** WITH AGGREGATE. OTHER RECOMMENDED PRIMERS INCLUDE: **HENRY LV PRIMER**, **HENRY STXL PRIMER** WITH AGGREGATE, **PUMADEQ PRIMER 20** WITH AGGREGATE AND **HENRY GC EPOXY PRIMER**. REFER TO PRODUCT SPECIFIC DATA SHEET FOR PRODUCT SPECIFIC INFORMATION.
3. FULLY BROADCAST, TO REJECTION, DRY SILICA SAND (SIEVE SIZE: #20-30) INTO WET **HENRY GP WEARCOAT**.
4. DO NOT INSTALL **PRODEQ** SYSTEM OVER SUBSTRATES/AREAS THAT EXCEED MAXIMUM MOISTURE ALLOWANCES. VERIFY DEFICIENCIES DO NOT HAVE PERCOLATING MOISTURE. REFER TO **PRODEQ** SYSTEM MOISTURE TEST METHODS TECH-TALK BULLETIN FOR FURTHER INFORMATION.
5. DO NOT INSTALL **PRODEQ** SYSTEM BEYOND PRIMED SURFACES.
6. HENRY OFFERS PAVERS, RIGID INSULATION, AND/OR PREFABRICATED DRAINAGE COMPOSITES AS A SINGLE SOURCE WARRANTY OPTION PER PROJECT SPECIFIC REQUIREMENTS (NOT SHOWN FOR CLARITY). CONTACT HENRY FOR SYSTEM CONFIGURATIONS AND WARRANTY OPTIONS.
7. REFER TO **PRODEQ** SYSTEM GUIDE SPECIFICATION FOR RECOMMENDED INSTALLATION PROCEDURES.

**Henry**<sup>®</sup>

999 N. Pacific Coast Highway, Suite 800  
El Segundo, CA 90245  
800-486-1278 • www.henry.com

MANUFACTURER GUIDE DETAILS ARE FOR REFERENCE ONLY. HENRY DOES NOT ASSUME RESPONSIBILITY FOR ERRORS OR DEVIATIONS IN DESIGN OR ENGINEERING. PROJECT SPECIFIC VERIFICATION IS RECOMMENDED PRIOR TO INSTALLATION.

**PRODEQ SYSTEM - WATERPROOFING ASSEMBLY**

**SUBSTRATE DEFICIENCY**

**DEFICIENCIES ON VERTICAL SUBSTRATES  
GREATER THAN 1/4" X 1/4" WITH TOP COAT**

SCALE: N.T.S.

11-07-2019

**PRODEQ-SC8**