

**PUMADEC™ SYSTEM WATERPROOFING ASSEMBLY
REINFORCED FIELD MEMBRANE SEQUENCE OF INSTALLATION**

- ① PUMADEC™ PRIMER 20 OR HENRY® GC PRIMER
- ② PUMADEC™ FLEX 31MV REINFORCED CORNER FLASHING
- ③ PUMADEC™ FLEX 31MV REINFORCED CORNER FLASHING (3A AND 3B)
- ④ PUMADEC™ FLEX 30SL REINFORCED FIELD MEMBRANE
- ⑤ OPTIONAL TOP/WEAR COAT AS SPECIFIED PER PROJECT SPECIFIC REQUIREMENTS (NOT SHOWN FOR CLARITY REFER TO PUMADEC™ SYSTEM DETAILS)
 - HENRY® DEQCOAT™ 50 TOP COAT
 - PUMADEC™ GRIP 40 WEAR COAT

**PUMADEC™ FLEX 31MV
REINFORCED FLASHING**

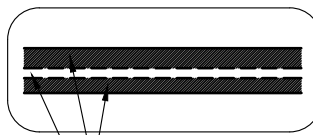

PUMADEC™ FLEX 31MV
PUMADEC™ N-FLEECE

**PUMADEC™ FLEX 30SL
REINFORCED FIELD MEMBRANE**

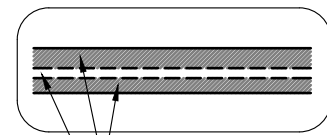

PUMADEC™ FLEX 30SL
PUMADEC™ N-FLEECE

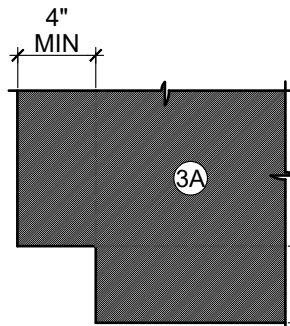
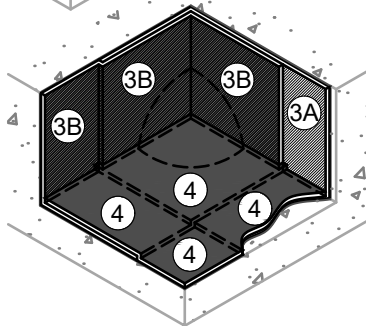
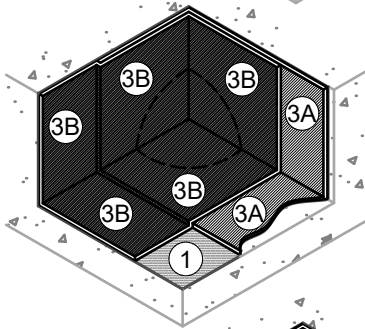
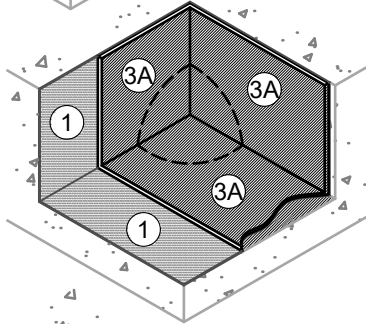
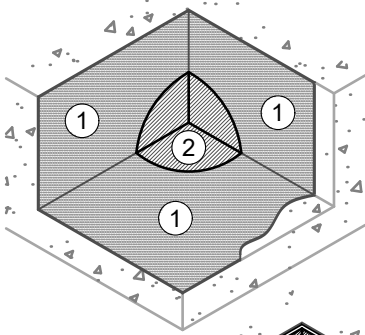

**PUMADEC™ N-FLEECE
CORNER UPTURN FLASHING**

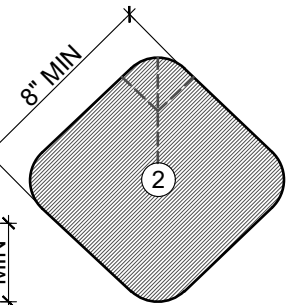
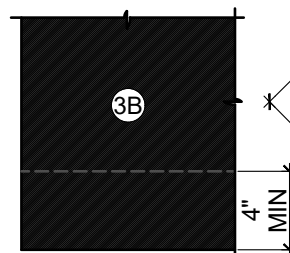

**PUMADEC™ N-FLEECE
CORNER FLASHING**

NOTES:

1. DETAIL SHOWS HENRY® PUMADEC™ SYSTEM WATERPROOFING ASSEMBLY WITH A REINFORCED FIELD MEMBRANE. SUBSTRATE SHOWN IS FOR REFERENCE ONLY. REFER TO PRODUCT SPECIFIC TECHNICAL DATA SHEET FOR AUTHORIZED SUBSTRATES.
2. PREPARE AND PRIME VERTICAL SUBSTRATES A MINIMUM 2" BEYOND PUMADEC™ SYSTEM APPLICATION IN ACCORDANCE WITH HENRY® PUMADEC™ SYSTEM SUBSTRATE PREPARATION GUIDELINES TECH-TALK BULLETIN.
3. DO NOT INSTALL PUMADEC™ SYSTEM BEYOND PRIMED SURFACES.
4. BACK COAT FLEECE ON VERTICAL SUBSTRATES WITH PUMADEC™ RESIN.
5. REFER TO PUMADEC™ SYSTEM GUIDE SPECIFICATION FOR RECOMMENDED INSTALLATION PROCEDURES.



999 N. Pacific Coast Highway, Suite 800
El Segundo, CA 90245
800-486-1278 • www.henry.com

MANUFACTURER GUIDE DETAILS ARE FOR REFERENCE ONLY. HENRY® DOES NOT ASSUME RESPONSIBILITY FOR ERRORS OR DEVIATIONS IN DESIGN OR ENGINEERING. PROJECT SPECIFIC VERIFICATION IS RECOMMENDED PRIOR TO INSTALLATION.

PUMADEC™ SYSTEM - WATERPROOFING ASSEMBLY

INSIDE CORNERS

**REINFORCED FIELD MEMBRANE
CORNER FLASHING AT UPTURN**

SCALE: N.T.S.

04-26-2019

PUMADEC-C2A