

GROWING MEDIA
(VEGETATION NOT
SHOWN FOR CLARITY)

FILTER FABRIC

OPTIONAL MOISTURE
RETENTION FABRIC

WATER RETENTION
AND DRAINAGE COMPOSITE

INSULATION

OPTIONAL DRAINAGE
COMPOSITE

ROOT BARRIER

MODIFIEDPLUS G100S/S

HENRY 790-11/790-11EV
2-PLY 215 MIL REINFORCED
WITH POLYESTER FABRIC

HENRY 910 ASPHALT
PRIMER OR HENRY 930
POLYMER MODIFIED ADHESIVE

MODIFIEDPLUS NP180S/S
OR **MODIFIEDPLUS G100S/S**
SET IN **HENRY 790-11** (125 MILS)

BACKER ROD AND HENRY 925 BES SEALANT

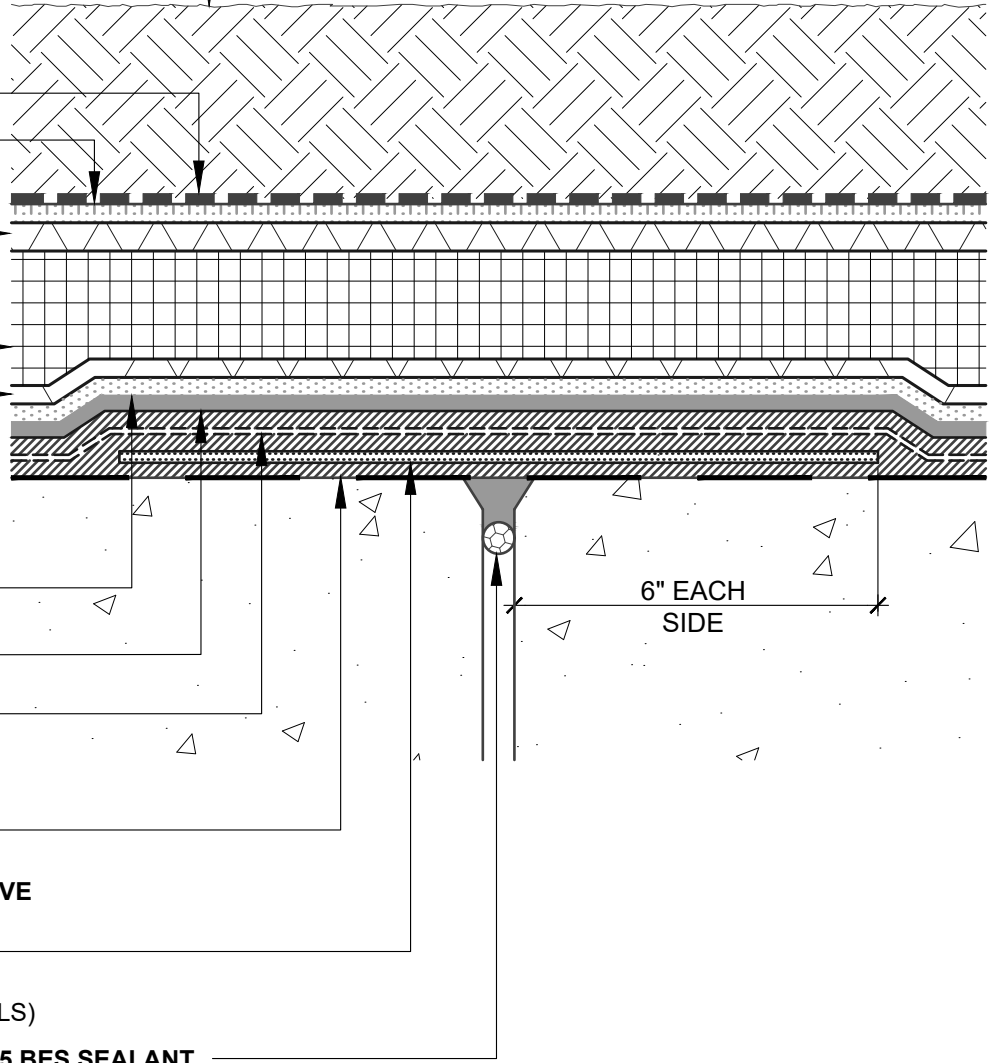

SUBSTRATE GAPS UP TO 1/2" WIDE

N.T.S

NOTES:

1. DETAIL SHOWS HENRY VEGETATIVE ROOFING WITH **HENRY 790-11/790-11EV** WATERPROOFING/ROOFING ASSEMBLY. SUBSTRATE SHOWN IS FOR REFERENCE ONLY. REFER TO PRODUCT SPECIFIC TECHNICAL DATA SHEET FOR AUTHORIZED SUBSTRATES.
2. DEPTH OF GROWING MEDIA MAY VARY DEPENDING ON PROJECT SPECIFIC REQUIREMENTS.
3. DETAIL IS FOR REFERENCE ONLY. REFER TO DESIGN PROFESSIONAL TO VERIFY WIND UPLIFT MINIMUM REQUIREMENTS.
4. THIS DETAIL IS INTENDED FOR NON-MOVING SUBSTRATE GAPS. REFER TO EXPANSION JOINT DETAILS FOR AREAS WHERE BUILDING MOVEMENT IS ANTICIPATED.
5. REFER TO THE VEGETATIVE ROOFING GUIDE SPECIFICATION FOR RECOMMENDED INSTALLATION PROCEDURES.

Henry[®]

999 N. Pacific Coast Hwy, Suite 800
El Segundo, CA 90245
800-486-1278 • www.henry.com

MANUFACTURER GUIDE DETAILS ARE FOR REFERENCE ONLY. HENRY DOES NOT ASSUME RESPONSIBILITY FOR ERRORS OR DEVIATIONS IN DESIGN OR ENGINEERING. PROJECT SPECIFIC VERIFICATION IS RECOMMENDED PRIOR TO INSTALLATION.

VEGETATIVE ROOFING - HENRY 790-11/790-11EV

NON-MOVING JOINT

HENRY 790-11 OR HENRY 790-11EV
PRECAST CONCRETE PLANK/PANEL JOINT TREATMENT

SCALE: N.T.S.

06-01-2020

VR-790-11-2E