

METAL FLASHING
(FOR REFERENCE ONLY - ACTUAL
CONDITIONS MAY VARY)

METAL FLASHING

FILTER FABRIC
PAVER SYSTEM OR
GRAVEL BALLAST
OPTIONAL MOISTURE
RETENTION FABRIC

WATER RETENTION
AND DRAINAGE
COMPOSITE

INSULATION

OPTIONAL
DRAINAGE
COMPOSITE

ROOT BARRIER

MODIFIEDPLUS G100S/S

HENRY 790-11/790-11EV
2-PLY 215 MIL REINFORCED
WITH **POLYESTER FABRIC**

HENRY 910 ASPHALT PRIMER
OR **HENRY 930 POLYMER**
MODIFIED ADHESIVE

NEOFLASH OR HENRY 990-25
SET IN **HENRY 790-11** (125 MILS)

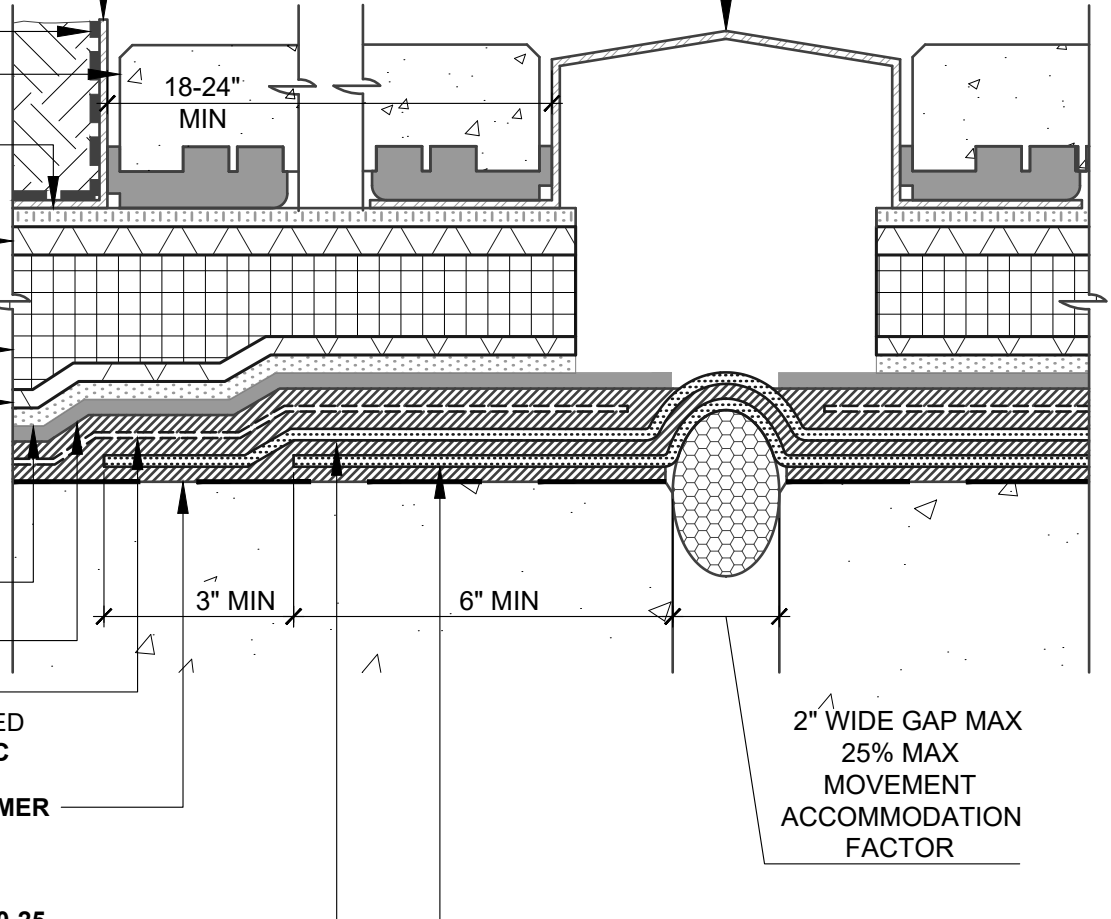

2" WIDE GAP MAX
25% MAX
MOVEMENT
ACCOMMODATION
FACTOR

NOTES:

1. DETAIL SHOWS HENRY VEGETATIVE ROOFING WITH **HENRY 790-11/790-11EV** WATERPROOFING/ROOFING ASSEMBLY. SUBSTRATE SHOWN IS FOR REFERENCE ONLY. REFER TO PRODUCT SPECIFIC TECHNICAL DATA SHEET FOR AUTHORIZED SUBSTRATES.
2. DEPTH OF GROWING MEDIA MAY VARY DEPENDING ON PROJECT SPECIFIC REQUIREMENTS.
3. DETAIL IS FOR REFERENCE ONLY. REFER TO DESIGN PROFESSIONAL TO VERIFY WIND UPLIFT MINIMUM REQUIREMENTS.
4. REFER TO THE VEGETATIVE ROOFING GUIDE SPECIFICATION FOR RECOMMENDED INSTALLATION PROCEDURES.

Henry[®]

999 N. Pacific Coast Hwy, Suite 800
El Segundo, CA 90245
800-486-1278 • www.henry.com

MANUFACTURER GUIDE DETAILS ARE FOR REFERENCE ONLY. HENRY DOES NOT ASSUME RESPONSIBILITY FOR ERRORS OR DEVIATIONS IN DESIGN OR ENGINEERING. PROJECT SPECIFIC VERIFICATION IS RECOMMENDED PRIOR TO INSTALLATION.

VEGETATIVE ROOFING - HENRY 790-11/790-11EV

EXPANSION JOINT

CONCEALED FLASHING
NEOFLASH OR HENRY 990-25

SCALE: N.T.S.

06-01-2020

VR-790-11-8A