

THIS SYSTEM REFLECTS A PARTNERSHIP WITH HENRY COMPANY AND GREEN ROOF OUTFITTERS (GRO) FOR VEGETATIVE ROOFING SYSTEMS IN HIGH VELOCITY HURRICANE ZONES. REFER TO SYSTEM SPECIFIC ASTM D3161 CERTIFICATE OF ANALYSIS FOR GROWING MEDIA DEPTH, WIND UPLIFT ANCHORING SYSTEM, PARAPET HEIGHT AND SET BACK REQUIREMENTS

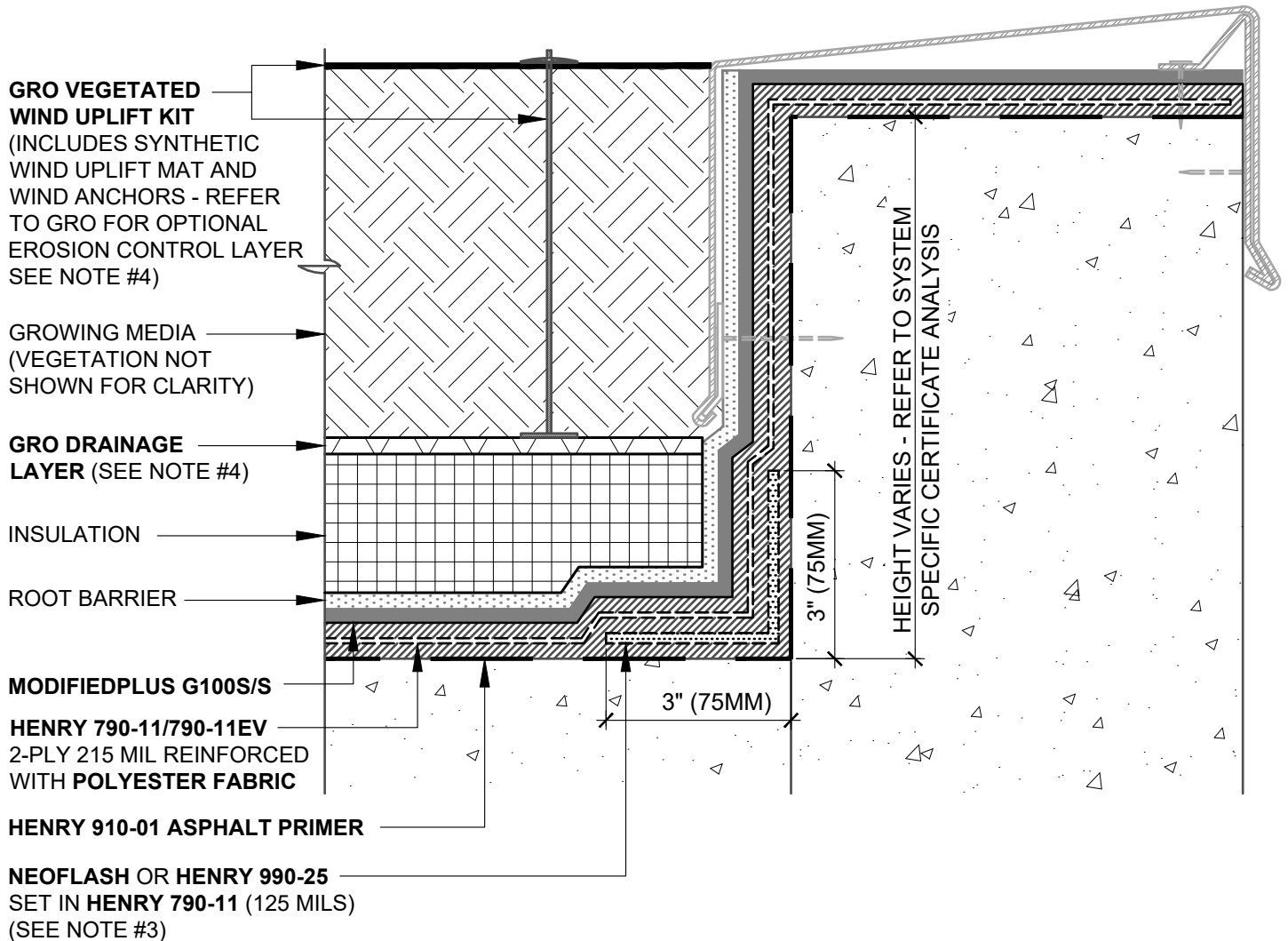

NOTES:

1. DETAIL SHOWS HENRY VEGETATIVE ROOFING WITH **HENRY 790-11/790-11EV** WATERPROOFING/ROOFING ASSEMBLY. THIS DETAIL IS BASED ON AN ASTM D3161 FOR WIND RESISTANT SYSTEM IN CONJUNCTION WITH GREEN ROOF OUTFITTERS (GRO). IT IS THE RESPONSIBILITY OF THE DESIGNER TO VERIFY ASTM D3161 COMPLIANCE.
2. ACCEPTABLE SUBSTRATES INCLUDE: STRUCTURAL CONCRETE.
3. FLASHING IS FOR REFERENCE ONLY. REFER TO **HENRY 790-11/790-11EV** WATERPROOFING/ROOFING ASSEMBLY DETAILS FOR VARIOUS FLASHING OPTIONS.
4. REFER TO SYSTEM SPECIFIC ASTM D3161 CERTIFICATE OF ANALYSIS FOR SYSTEM SPECIFIC COMPONENTS, GROWING MEDIA DEPTH, PARAPET HEIGHT AND SET BACK REQUIREMENTS.
5. WIND UPLIFT MAT AND WIND ANCHOR SYSTEM ARE OPTIONAL AND DEPENDANT UPON SYSTEM REQUIREMENTS. REFER TO SYSTEM SPECIFIC ASTM D3161 CERTIFICATE OF ANALYSIS FOR SYSTEM SPECIFIC REQUIREMENTS.
6. REFER TO THE VEGETATIVE ROOFING GUIDE SPECIFICATION FOR RECOMMENDED INSTALLATION PROCEDURES.

Henry[®]

999 N. Pacific Coast Hwy, Suite 800
El Segundo, CA 90245
800-486-1278 • www.henry.com

MANUFACTURER GUIDE DETAILS ARE FOR REFERENCE ONLY. HENRY DOES NOT ASSUME RESPONSIBILITY FOR ERRORS OR DEVIATIONS IN DESIGN OR ENGINEERING. PROJECT SPECIFIC VERIFICATION IS RECOMMENDED PRIOR TO INSTALLATION.

VEGETATIVE ROOFING - HENRY 790-11/790-11EV

HVHZ SYSTEM

**HIGH VELOCITY HURRICANE ZONE (HVHZ) SYSTEM
VEGETATIVE ROOF AT PARAPET**

SCALE: N.T.S.

06-29-2021

VR-790-11-W1C