

FILL BUG HOLES/VOIDS WITH
CONCRETE REPAIR
MORTAR/GROUT AND ALLOW TO
FULLY CURE PRIOR TO
MEMBRANE APPLICATION

OPTIONAL **HENRY GP TOPCOAT**
(20 MILS)

HENRY PRODEQ FX 400 (100 MILS)

PRIMER (SEE NOTE #2)

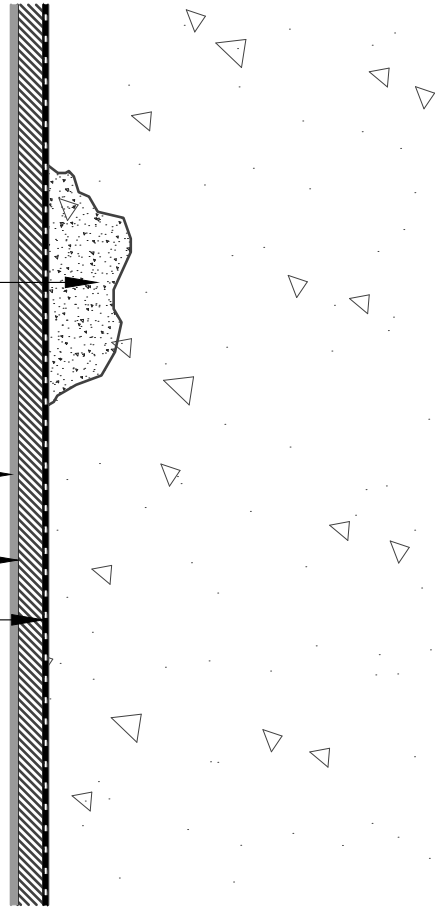

NOTES:

1. DETAIL SHOWS HENRY VEGETATIVE ROOFING WITH **PRODEQ** SYSTEM WATERPROOFING ASSEMBLY. SUBSTRATE SHOWN IS FOR REFERENCE ONLY. REFER TO PRODUCT SPECIFIC TECHNICAL DATA SHEET FOR AUTHORIZED SUBSTRATES.
2. THE STANDARD PRIMER FOR THE HENRY **PRODEQ** SYSTEM IS **HENRY ST PRIMER** WITH AGGREGATE. OTHER RECOMMENDED PRIMERS INCLUDE: **HENRY LV PRIMER**, **HENRY STXL PRIMER** WITH AGGREGATE, **PUMADEQ PRIMER 20** WITH AGGREGATE AND **HENRY GC EPOXY PRIMER**. REFER TO PRODUCT SPECIFIC DATA SHEET FOR PRODUCT SPECIFIC INFORMATION.
3. DO NOT INSTALL **PRODEQ** SYSTEM OVER SUBSTRATES/AREAS THAT EXCEED MAXIMUM MOISTURE ALLOWANCES. VERIFY DEFICIENCIES DO NOT HAVE PERCOLATING MOISTURE. REFER TO **PRODEQ** SYSTEM MOISTURE TEST METHODS TECH-TALK BULLETIN FOR FURTHER INFORMATION.
4. DO NOT INSTALL **PRODEQ** SYSTEM BEYOND PRIMED SURFACES.
5. DEPTH OF GROWING MEDIA MAY VARY DEPENDING ON PROJECT SPECIFIC REQUIREMENTS.
6. DETAIL IS FOR REFERENCE ONLY. REFER TO DESIGN PROFESSIONAL TO VERIFY WIND UPLIFT MINIMUM REQUIREMENTS.
7. REFER TO **PRODEQ** SYSTEM GUIDE SPECIFICATION AND WATERPROOFING DETAILS FOR RECOMMENDED INSTALLATION PROCEDURES.

Henry®

999 N. Pacific Coast Hwy, Suite 800
El Segundo, CA 90245
800-486-1278 • www.henry.com

MANUFACTURER GUIDE DETAILS ARE FOR REFERENCE ONLY. HENRY DOES NOT ASSUME RESPONSIBILITY FOR ERRORS OR DEVIATIONS IN DESIGN OR ENGINEERING. PROJECT SPECIFIC VERIFICATION IS RECOMMENDED PRIOR TO INSTALLATION.

VEGETATIVE ROOFING - PRODEQ SYSTEM

SUBSTRATE DEFICIENCY
TYPICAL PRODEQ SYSTEM - DEFICIENCIES ON
VERTICAL SUBSTRATES GREATER THAN 1/4" X 1/4"

SCALE: N.T.S.

06-01-2020

VR-PDEQ-2D