

EDGE DETAIL NOT APPLICABLE FOR ALL BUILDING TYPES AND REGIONS. EDGE DETAIL AND BALLAST MAY REQUIRE A PARAPET AND/OR PAVER STRAPS TO MEET MINIMUM WIND UPLIFT REQUIREMENTS. REFER TO DESIGN PROFESSIONAL TO CONFIRM WIND UPLIFT AND ROOF EDGE REQUIREMENTS.

PERFORATED EDGE RESTRAINT

GROWING MEDIA  
(VEGETATION NOT SHOWN FOR CLARITY)

FILTER FABRIC

OPTIONAL MOISTURE  
RETENTION FABRIC

WATER RETENTION  
AND DRAINAGE  
COMPOSITE

INSULATION

OPTIONAL DRAINAGE  
COMPOSITE

**HENRY PRODEQ FX 400**  
(100 MILS)

PRIMER (SEE NOTE #2)

**HENRY PRODEQ FX 400**  
(40 MILS)

WIDTH VARIES: DESIGN  
PROFESSIONAL TO CONFIRM  
WIND UPLIFT REQUIREMENTS

3" MIN

FOR REFERENCE ONLY - METAL EDGE DESIGN AND FASTENING METHODS AS SPECIFIED BY OTHERS

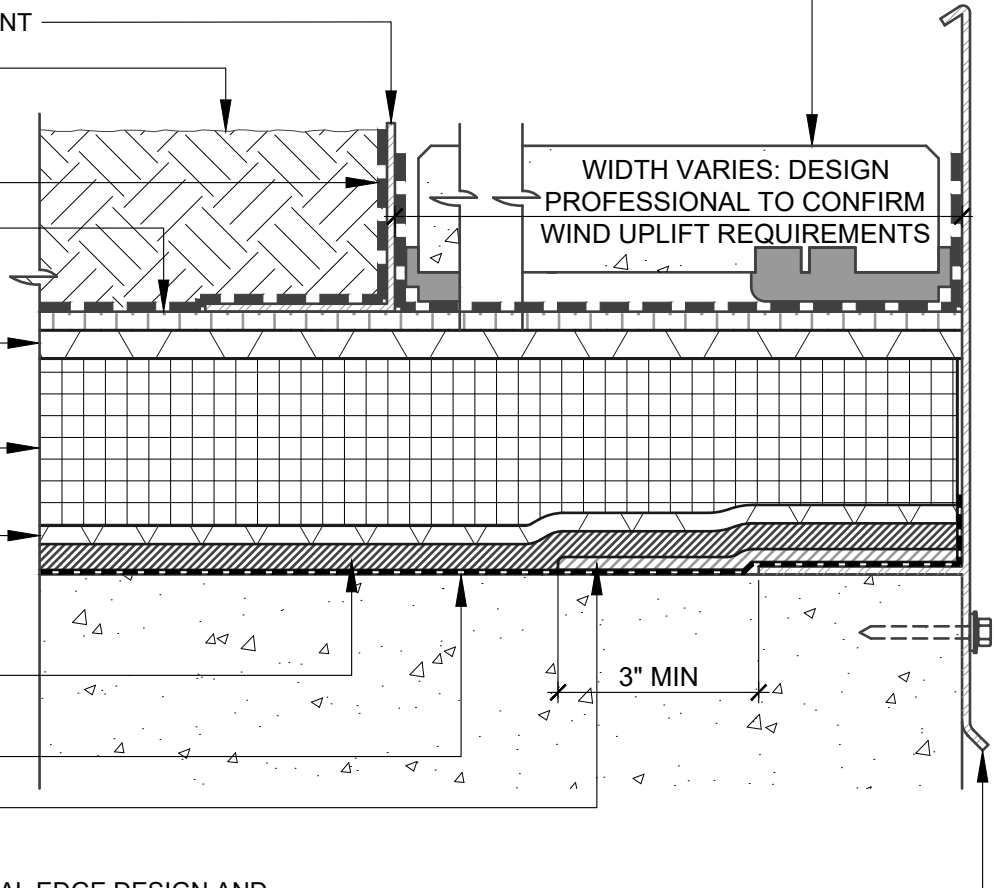

**NOTES:**

1. DETAIL SHOWS HENRY VEGETATIVE ROOFING WITH **PRODEQ** SYSTEM WATERPROOFING ASSEMBLY. SUBSTRATE SHOWN IS FOR REFERENCE ONLY. REFER TO PRODUCT SPECIFIC TECHNICAL DATA SHEET FOR AUTHORIZED SUBSTRATES.
2. THE STANDARD PRIMER FOR THE HENRY **PRODEQ** SYSTEM IS **HENRY ST PRIMER** WITH AGGREGATE. OTHER RECOMMENDED PRIMERS INCLUDE: **HENRY LV PRIMER**, **HENRY STXL PRIMER** WITH AGGREGATE, **PUMADEQ PRIMER 20** WITH AGGREGATE AND **HENRY GC EPOXY PRIMER**. REFER TO PRODUCT SPECIFIC DATA SHEET FOR PRODUCT SPECIFIC INFORMATION.
3. DO NOT INSTALL **PRODEQ** SYSTEM BEYOND PRIMED SURFACES.
4. DEPTH OF GROWING MEDIA MAY VARY DEPENDING ON PROJECT SPECIFIC REQUIREMENTS.
5. DETAIL IS FOR REFERENCE ONLY. REFER TO DESIGN PROFESSIONAL TO VERIFY WIND UPLIFT MINIMUM REQUIREMENTS.
6. REFER TO THE **PRODEQ** SYSTEM GUIDE SPECIFICATION AND WATERPROOFING DETAILS FOR RECOMMENDED INSTALLATION PROCEDURES.

**Henry**<sup>®</sup>

999 N. Pacific Coast Hwy, Suite 800  
El Segundo, CA 90245  
800-486-1278 • www.henry.com

MANUFACTURER GUIDE DETAILS ARE FOR REFERENCE ONLY. HENRY DOES NOT ASSUME RESPONSIBILITY FOR ERRORS OR DEVIATIONS IN DESIGN OR ENGINEERING. PROJECT SPECIFIC VERIFICATION IS RECOMMENDED PRIOR TO INSTALLATION.

**VEGETATIVE ROOFING - PRODEQ SYSTEM**

**ROOF EDGE**

**METAL EDGE IN LIEU OF PARAPET  
DETAIL NOT APPLICABLE FOR ALL BUILDING TYPES**

SCALE: N.T.S.

06-01-2020

**VR-PDEQ-3F**