

EDGE DETAIL NOT APPLICABLE FOR ALL BUILDING TYPES AND/OR REGIONS. EDGE DETAIL AND BALLAST MAY REQUIRE A PARAPET AND/OR PAVER STRAPS TO MEET MINIMUM WIND UPLIFT REQUIREMENTS. REFER TO DESIGN PROFESSIONAL TO CONFIRM WIND UPLIFT AND ROOF EDGE REQUIREMENTS.

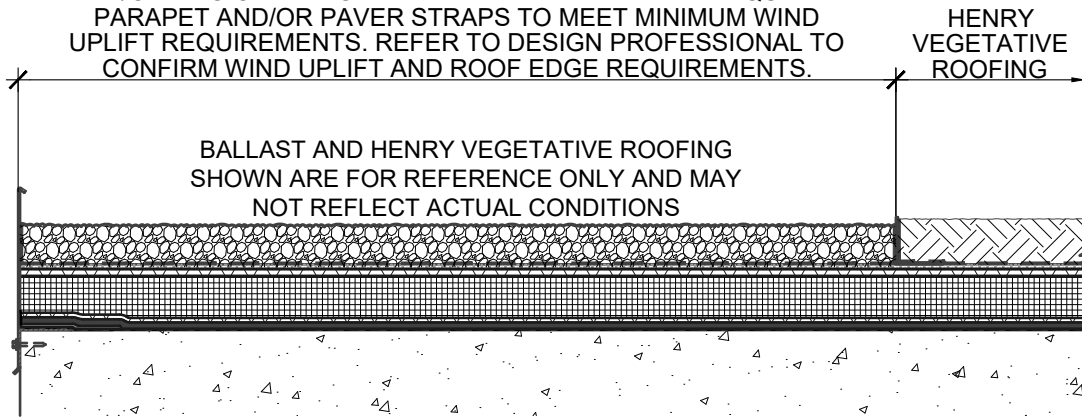

**VEGETATIVE FREE ZONE EXAMPLE AT ROOF EDGE**

N.T.S

VARIES  
(SEE NOTE #4)

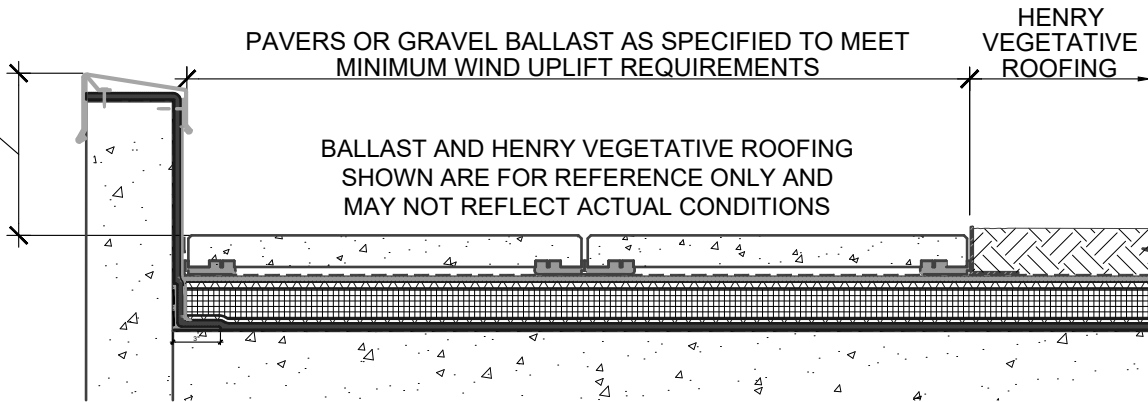

**VEGETATIVE FREE ZONE EXAMPLE AT PARAPET**

N.T.S

**NOTES:**

1. DETAIL SHOWS HENRY VEGETATIVE ROOFING WITH **PRODEQ** SYSTEM WATERPROOFING ASSEMBLY. SUBSTRATE SHOWN IS FOR REFERENCE ONLY. REFER TO PRODUCT SPECIFIC TECHNICAL DATA SHEET FOR AUTHORIZED SUBSTRATES.
2. THE STANDARD PRIMER FOR THE HENRY **PRODEQ** SYSTEM IS **HENRY ST PRIMER** WITH AGGREGATE. OTHER RECOMMENDED PRIMERS INCLUDE: **HENRY LV PRIMER**, **HENRY STXL PRIMER** WITH AGGREGATE, **PUMADEQ PRIMER 20** WITH AGGREGATE AND **HENRY GC EPOXY PRIMER**. REFER TO PRODUCT SPECIFIC DATA SHEET FOR PRODUCT SPECIFIC INFORMATION.
3. EDGE DETAIL NOT APPLICABLE FOR ALL BUILDING TYPES OR REGIONS. BUILDING MAY REQUIRE PARAPET AND/OR PAVER STRAPS TO MEET MINIMUM WIND UPLIFT REQUIREMENTS.
4. DO NOT INSTALL **PRODEQ** SYSTEM BEYOND PRIMED SURFACES.
5. DEPTH OF GROWING MEDIA MAY VARY DEPENDING ON PROJECT SPECIFIC REQUIREMENTS.
6. DETAIL IS FOR REFERENCE ONLY. REFER TO DESIGN PROFESSIONAL TO VERIFY WIND UPLIFT MINIMUM REQUIREMENTS.
7. REFER TO THE **PRODEQ** GUIDE SPECIFICATION AND WATERPROOFING DETAILS FOR RECOMMENDED INSTALLATION PROCEDURES.



999 N. Pacific Coast Hwy, Suite 800  
El Segundo, CA 90245  
800-486-1278 • www.henry.com

MANUFACTURER GUIDE DETAILS ARE FOR REFERENCE ONLY. HENRY DOES NOT ASSUME RESPONSIBILITY FOR ERRORS OR DEVIATIONS IN DESIGN OR ENGINEERING. PROJECT SPECIFIC VERIFICATION IS RECOMMENDED PRIOR TO INSTALLATION.

**VEGETATIVE ROOFING - PRODEQ SYSTEM**

**VEGETATIVE FREE ZONE**

**EXAMPLE OF POSSIBLE PARAPET /ROOF EDGE CONDITIONS AT A VEGETATIVE ROOFING**

SCALE: N.T.S.

06-01-2020

**VR-PDEQ-3**