

PARAPET TERMINATION

N.T.S

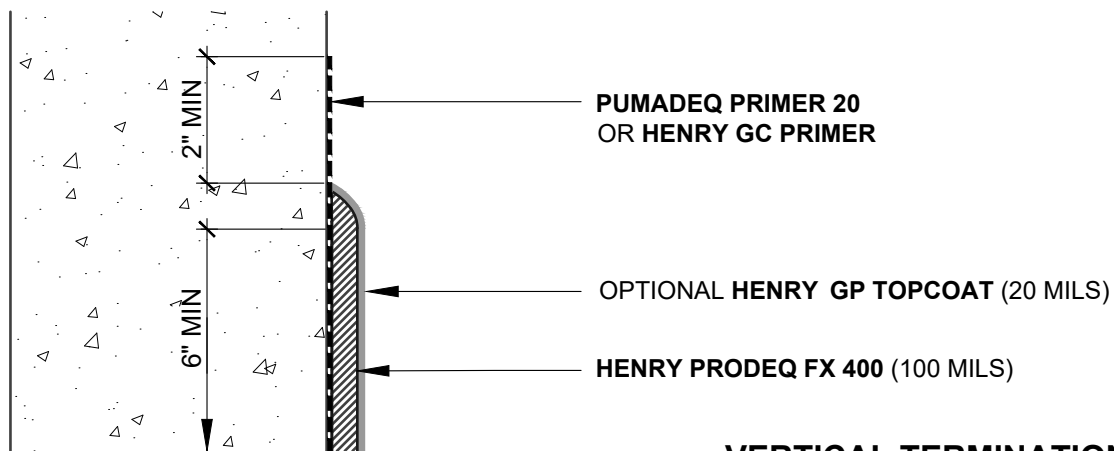

VERTICAL TERMINATION

N.T.S

NOTES:

1. DETAIL SHOWS HENRY VEGETATIVE ROOFING WITH **PRODEQ** SYSTEM WATERPROOFING ASSEMBLY. SUBSTRATE SHOWN IS FOR REFERENCE ONLY. REFER TO PRODUCT SPECIFIC TECHNICAL DATA SHEET FOR AUTHORIZED SUBSTRATES.
2. THE STANDARD PRIMER FOR THE HENRY **PRODEQ** SYSTEM IS **HENRY ST PRIMER** WITH AGGREGATE. OTHER RECOMMENDED PRIMERS INCLUDE: **HENRY LV PRIMER**, **HENRY STXL PRIMER** WITH AGGREGATE, **PUMADEC PRIMER 20** WITH AGGREGATE AND **HENRY GC EPOXY PRIMER**. REFER TO PRODUCT SPECIFIC DATA SHEET FOR PRODUCT SPECIFIC INFORMATION.
3. DO NOT INSTALL **PRODEQ** SYSTEM BEYOND PRIMED SURFACES.
4. DEPTH OF GROWING MEDIA MAY VARY DEPENDING ON PROJECT SPECIFIC REQUIREMENTS.
5. DETAIL IS FOR REFERENCE ONLY. REFER TO DESIGN PROFESSIONAL TO VERIFY WIND UPLIFT MINIMUM REQUIREMENTS.
6. REFER TO THE **PRODEQ** SYSTEM GUIDE SPECIFICATION AND WATERPROOFING DETAILS FOR RECOMMENDED INSTALLATION PROCEDURES.

Henry®

999 N. Pacific Coast Hwy, Suite 800
El Segundo, CA 90245
800-486-1278 • www.henry.com

MANUFACTURER GUIDE DETAILS ARE FOR REFERENCE ONLY. HENRY DOES NOT ASSUME RESPONSIBILITY FOR ERRORS OR DEVIATIONS IN DESIGN OR ENGINEERING. PROJECT SPECIFIC VERIFICATION IS RECOMMENDED PRIOR TO INSTALLATION.

VEGETATIVE ROOFING - PRODEQ SYSTEM

TERMINATION OPTIONS

PRODEQ TERMINATION OPTIONS
ON A VERTICAL SUBSTRATE

SCALE: N.T.S.

06-01-2020

VR-PDEQ-6A