

METAL FLASHING
(FOR REFERENCE ONLY - ACTUAL
CONDITIONS MAY VARY)

PAVER SYSTEM OR
GRAVEL BALLAST

METAL FLASHING

FILTER FABRIC

OPTIONAL MOISTURE
RETENTION FABRIC

WATER RETENTION
AND DRAINAGE
COMPOSITE

INSULATION

OPTIONAL
DRAINAGE
COMPOSITE

HENRY PRODEQ FX 400
(100 MILS)

PRIMER (SEE NOTE #2)

PREFABRICATED
EXPANSION JOINT BY
OTHERS AS SPECIFIED

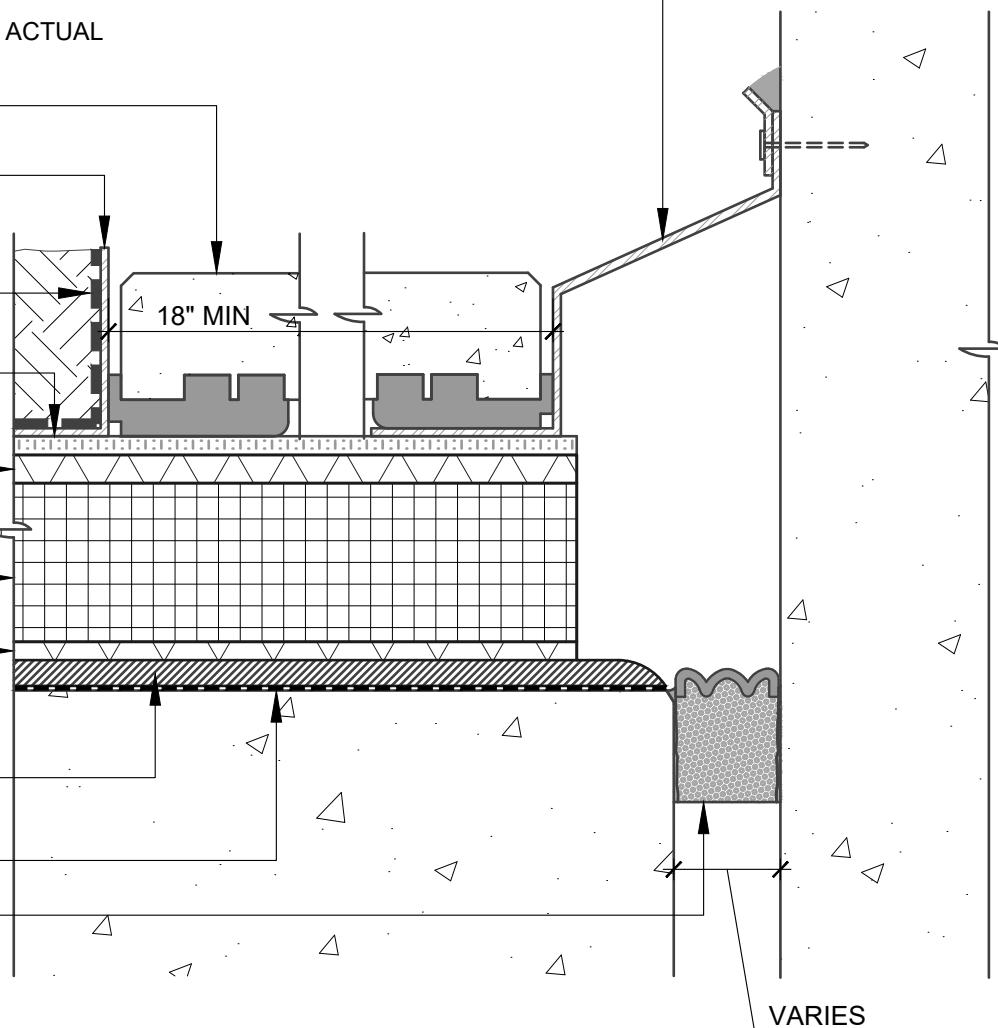

NOTES:

1. DETAIL SHOWS HENRY VEGETATIVE ROOFING WITH **PRODEQ** SYSTEM WATERPROOFING ASSEMBLY. SUBSTRATE SHOWN IS FOR REFERENCE ONLY. REFER TO PRODUCT SPECIFIC TECHNICAL DATA SHEET FOR AUTHORIZED SUBSTRATES.
2. THE STANDARD PRIMER FOR THE HENRY **PRODEQ** SYSTEM IS **HENRY ST PRIMER** WITH AGGREGATE. OTHER RECOMMENDED PRIMERS INCLUDE: **HENRY LV PRIMER**, **HENRY STXL PRIMER** WITH AGGREGATE, **PUMADEQ PRIMER 20** WITH AGGREGATE AND **HENRY GC EPOXY PRIMER**. REFER TO PRODUCT SPECIFIC DATA SHEET FOR PRODUCT SPECIFIC INFORMATION.
3. DO NOT INSTALL **PRODEQ** SYSTEM BEYOND PRIMED SURFACES.
4. DETAIL IS FOR REFERENCE ONLY. CONTACT EXPANSION JOINT MANUFACTURER FOR PROJECT SPECIFIC REQUIREMENTS.
5. EXPANSION JOINT MANUFACTURED AND INSTALLED BY OTHERS AS SPECIFIED. CONTACT HENRY FOR PROJECT SPECIFIC COORDINATION OF **PRODEQ** SYSTEM WITH EXPANSION JOINT.
6. DEPTH OF GROWING MEDIA MAY VARY DEPENDING ON PROJECT SPECIFIC REQUIREMENTS.
7. DETAIL IS FOR REFERENCE ONLY. REFER TO DESIGN PROFESSIONAL TO VERIFY WIND UPLIFT MINIMUM REQUIREMENTS.
8. REFER TO THE **PRODEQ** SYSTEM GUIDE SPECIFICATION AND WATERPROOFING DETAILS FOR RECOMMENDED INSTALLATION PROCEDURES.

Henry[®]

999 N. Pacific Coast Hwy, Suite 800
El Segundo, CA 90245
800-486-1278 • www.henry.com

MANUFACTURER GUIDE DETAILS ARE FOR REFERENCE ONLY. HENRY[®] DOES NOT ASSUME RESPONSIBILITY FOR ERRORS OR DEVIATIONS IN DESIGN OR ENGINEERING. PROJECT SPECIFIC VERIFICATION IS RECOMMENDED PRIOR TO INSTALLATION.

VEGETATIVE ROOFING - PRODEQ SYSTEM

EXPANSION JOINT

**TYPICAL PRODEQ SYSTEM
PREFABRICATED EXPANSION JOINT**

SCALE: N.T.S.

06-01-2020

VR-PDEQ-8B