

EDGE DETAIL NOT APPLICABLE FOR ALL BUILDING TYPES AND REGIONS. EDGE DETAIL AND BALLAST MAY REQUIRE A PARAPET AND/OR PAVER STRAPS TO MEET MINIMUM WIND UPLIFT REQUIREMENTS. REFER TO DESIGN PROFESSIONAL TO CONFIRM WIND UPLIFT AND ROOF EDGE REQUIREMENTS.

PERFORATED EDGE RESTRAINT

GROWING MEDIA  
(VEGETATION NOT SHOWN FOR CLARITY)

FILTER FABRIC

OPTIONAL MOISTURE  
RETENTION FABRIC

WATER RETENTION  
AND DRAINAGE  
COMPOSITE

INSULATION

OPTIONAL DRAINAGE  
COMPOSITE

ROOT BARRIER

**PUMADEQ FLEX 30SL**  
2-PLY 80 MIL REINFORCED  
WITH **PUMADEQ N-FLEECE**

**PUMADEQ FLEX 30SL**  
2-PLY 80 MIL REINFORCED  
WITH **PUMADEQ N-FLEECE**

**PUMADEQ PRIMER 20**  
OR **HENRY GC PRIMER**

FOR REFERENCE ONLY - METAL EDGE DESIGN AND FASTENING METHODS AS SPECIFIED BY OTHERS

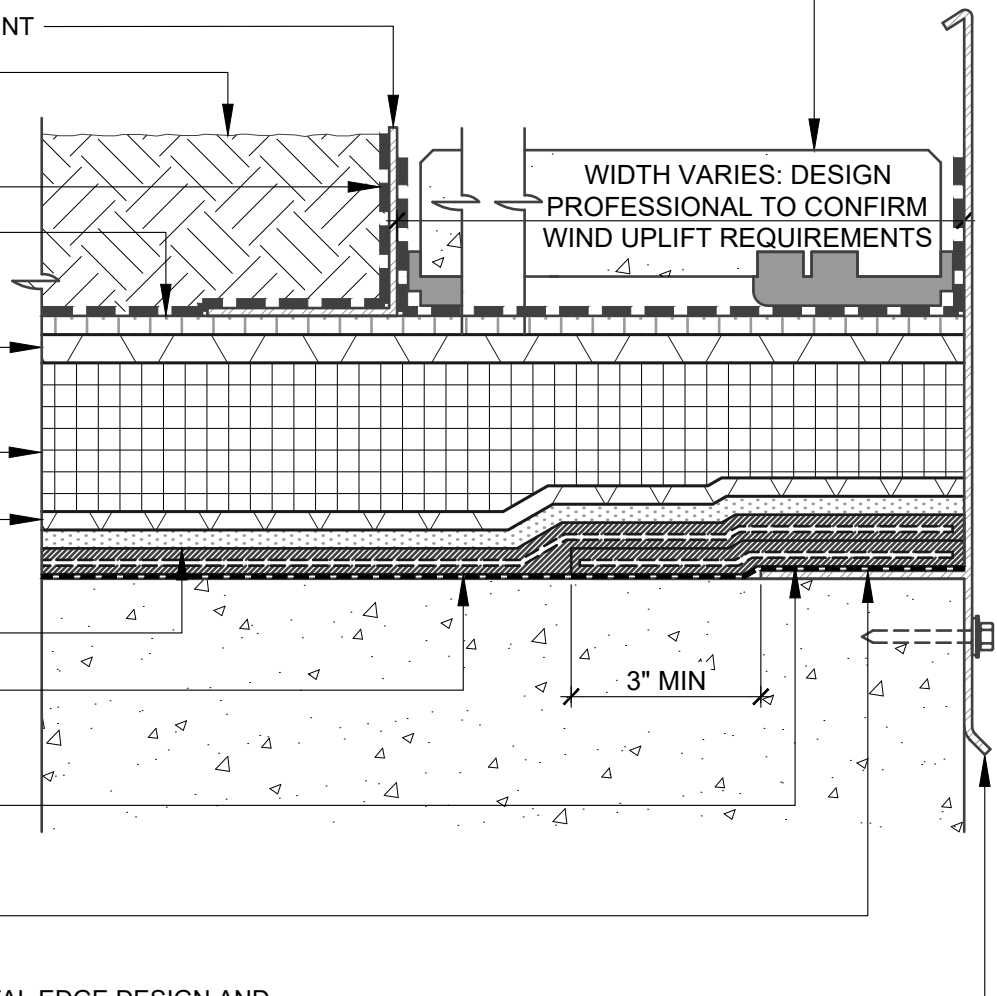

**NOTES:**

1. DETAIL SHOWS HENRY VEGETATIVE ROOFING WITH **PUMADEQ** SYSTEM WATERPROOFING ASSEMBLY WITH A REINFORCED FIELD MEMBRANE. SUBSTRATE SHOWN IS FOR REFERENCE ONLY. REFER TO PRODUCT SPECIFIC TECHNICAL DATA SHEET FOR AUTHORIZED SUBSTRATES.
2. DO NOT INSTALL **PUMADEQ** SYSTEM BEYOND PRIMED SURFACES.
3. DEPTH OF GROWING MEDIA MAY VARY DEPENDING ON PROJECT SPECIFIC REQUIREMENTS.
4. DETAIL IS FOR REFERENCE ONLY. REFER TO DESIGN PROFESSIONAL TO VERIFY WIND UPLIFT REQUIREMENTS.
5. REFER TO THE **PUMADEQ** SYSTEM GUIDE SPECIFICATION AND WATERPROOFING DETAILS FOR RECOMMENDED INSTALLATION PROCEDURES.



999 N. Pacific Coast Hwy, Suite 800  
El Segundo, CA 90245  
800-486-1278 • www.henry.com

MANUFACTURER GUIDE DETAILS ARE FOR REFERENCE ONLY. HENRY DOES NOT ASSUME RESPONSIBILITY FOR ERRORS OR DEVIATIONS IN DESIGN OR ENGINEERING. PROJECT SPECIFIC VERIFICATION IS RECOMMENDED PRIOR TO INSTALLATION.

**VEGETATIVE ROOFING - PUMADEQ SYSTEM**

**ROOF EDGE**  
**REINFORCED FIELD MEMBRANE (CSP 3-5)**  
**METAL EDGE IN LIEU OF PARAPET**

SCALE: N.T.S. 06-01-2020

**VR-PUMA-R3C**