

### PARAPET TERMINATION

N.T.S

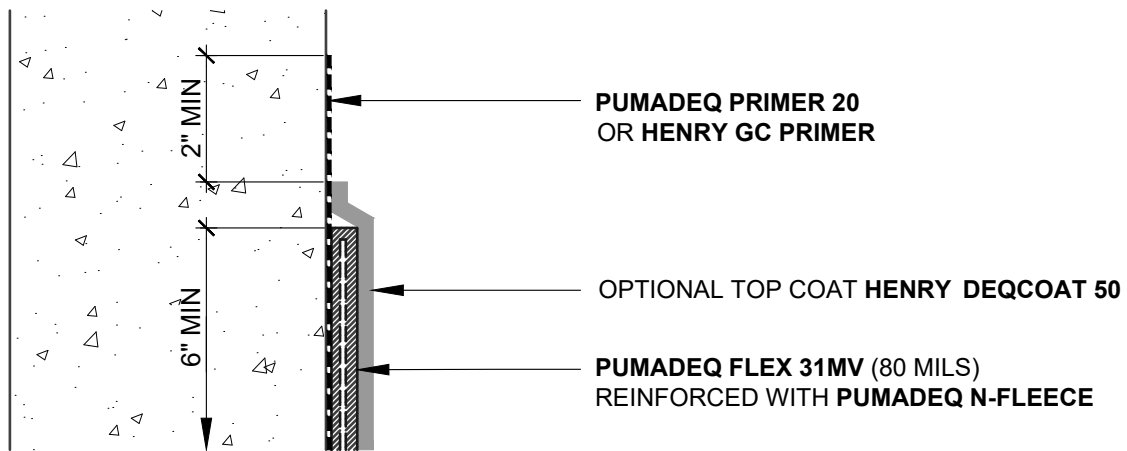

### VERTICAL TERMINATION

N.T.S

#### NOTES:

1. DETAIL SHOWS HENRY VEGETATIVE ROOFING WITH **PUMADEC** SYSTEM WATERPROOFING ASSEMBLY WITH A REINFORCED FIELD MEMBRANE. SUBSTRATE SHOWN IS FOR REFERENCE ONLY. REFER TO PRODUCT SPECIFIC TECHNICAL DATA SHEET FOR AUTHORIZED SUBSTRATES.
2. DO NOT INSTALL **PUMADEC** SYSTEM BEYOND PRIMED SURFACES.
3. BACK COAT FLEECE ON VERTICAL SURFACES WITH **PUMADEC** RESIN.
4. DEPTH OF GROWING MEDIA MAY VARY DEPENDING ON PROJECT SPECIFIC REQUIREMENTS.
5. DETAIL IS FOR REFERENCE ONLY. REFER TO DESIGN PROFESSIONAL TO VERIFY WIND UPLIFT REQUIREMENTS.
6. REFER TO THE **PUMADEC** SYSTEM GUIDE SPECIFICATION AND WATERPROOFING DETAILS FOR RECOMMENDED INSTALLATION PROCEDURES.

# Henry®

999 N. Pacific Coast Hwy, Suite 800  
El Segundo, CA 90245  
800-486-1278 • www.henry.com

MANUFACTURER GUIDE DETAILS ARE FOR REFERENCE ONLY. HENRY DOES NOT ASSUME RESPONSIBILITY FOR ERRORS OR DEVIATIONS IN DESIGN OR ENGINEERING. PROJECT SPECIFIC VERIFICATION IS RECOMMENDED PRIOR TO INSTALLATION.

## VEGETATIVE ROOFING - PUMADEC SYSTEM

### TERMINATION OPTIONS

REINFORCED FIELD MEMBRANE (CSP 3-5)  
VERTICAL TERMINATION OPTIONS

SCALE: N.T.S.

06-01-2020

VR-PUMA-R6