

EDGE DETAIL NOT APPLICABLE FOR ALL BUILDING TYPES AND REGIONS. EDGE DETAIL AND BALLAST MAY REQUIRE A PARAPET AND/OR PAVER STRAPS TO MEET MINIMUM WIND UPLIFT REQUIREMENTS. REFER TO DESIGN PROFESSIONAL TO CONFIRM WIND UPLIFT AND ROOF EDGE REQUIREMENTS.

PERFORATED EDGE RESTRAINT

GROWING MEDIA
(VEGETATION NOT SHOWN FOR CLARITY)

FILTER FABRIC

OPTIONAL MOISTURE
RETENTION FABRIC

WATER RETENTION
AND DRAINAGE
COMPOSITE

INSULATION

OPTIONAL DRAINAGE
COMPOSITE

ROOT BARRIER

PUMADEQ FLEX 30SL
(WHITE - 30 MILS)

PUMADEQ FLEX 30SL
(GRAY - 50 MILS)

PUMADEQ FLEX 30SL
2-PLY 80 MIL REINFORCED
WITH **PUMADEQ N-FLEECE**

PUMADEQ PRIMER 20
OR **HENRY GC PRIMER**

FOR REFERENCE ONLY - METAL EDGE DESIGN AND FASTENING METHODS AS SPECIFIED BY OTHERS

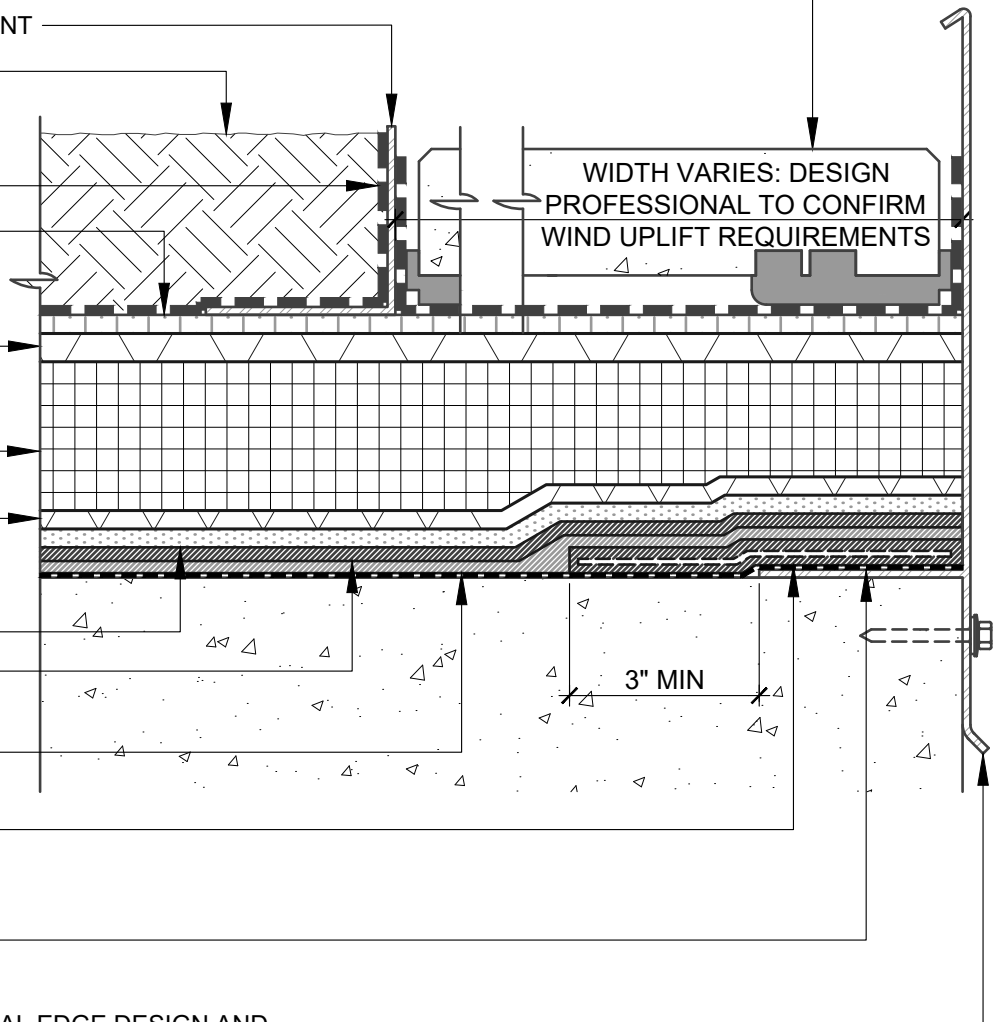

NOTES:

1. DETAIL SHOWS HENRY VEGETATIVE ROOFING WITH **PUMADEQ** SYSTEM WATERPROOFING ASSEMBLY WITH AN UNREINFORCED FIELD MEMBRANE. SUBSTRATE SHOWN IS FOR REFERENCE ONLY. REFER TO PRODUCT SPECIFIC TECHNICAL DATA SHEET FOR AUTHORIZED SUBSTRATES.
2. SURFACE PROFILES MUST MEET ICRI CSP 3-4. IF CSP 5, REFER TO REINFORCED **PUMADEQ** SYSTEM DETAILS.
3. DO NOT INSTALL **PUMADEQ** SYSTEM BEYOND PRIMED SURFACES.
4. DEPTH OF GROWING MEDIA MAY VARY DEPENDING ON PROJECT SPECIFIC REQUIREMENTS.
5. DETAIL IS FOR REFERENCE ONLY. REFER TO DESIGN PROFESSIONAL TO VERIFY WIND UPLIFT REQUIREMENTS.
6. REFER TO THE **PUMADEQ** SYSTEM GUIDE SPECIFICATION AND WATERPROOFING DETAILS FOR RECOMMENDED INSTALLATION PROCEDURES.

MANUFACTURER GUIDE DETAILS ARE FOR REFERENCE ONLY. HENRY DOES NOT ASSUME RESPONSIBILITY FOR ERRORS OR DEVIATIONS IN DESIGN OR ENGINEERING. PROJECT SPECIFIC VERIFICATION IS RECOMMENDED PRIOR TO INSTALLATION.

VEGETATIVE ROOFING - PUMADEQ SYSTEM

ROOF EDGE
UNREINFORCED FIELD MEMBRANE (CSP 3-4)
METAL EDGE IN LIEU OF PARAPET

SCALE: N.T.S. 06-01-2020

VR-PUMA-U3C



999 N. Pacific Coast Hwy, Suite 800
El Segundo, CA 90245
800-486-1278 • www.henry.com