

PARAPET TERMINATION

N.T.S

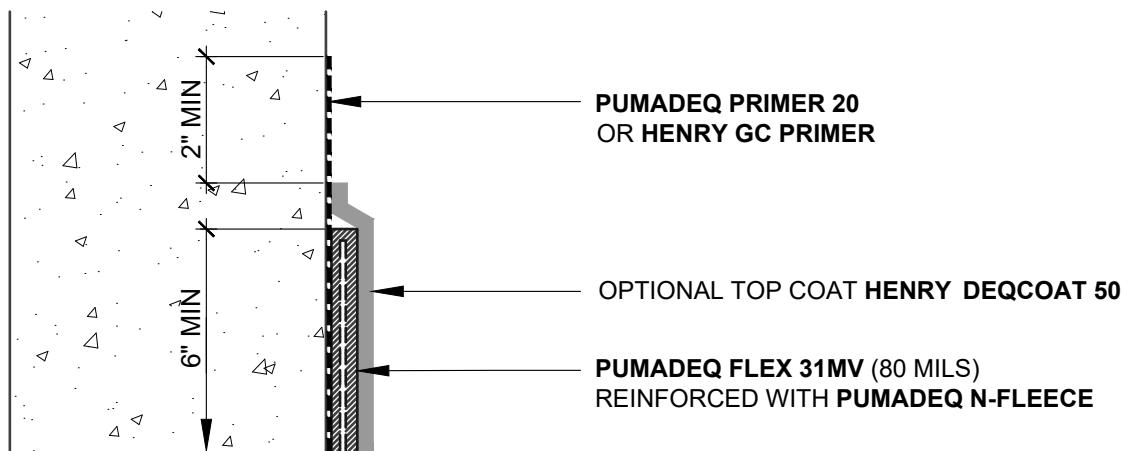

VERTICAL TERMINATION

N.T.S

NOTES:

1. DETAIL SHOWS HENRY VEGETATIVE ROOFING WITH **PUMADEC** SYSTEM WATERPROOFING ASSEMBLY WITH AN UNREINFORCED FIELD MEMBRANE. SUBSTRATE SHOWN IS FOR REFERENCE ONLY. REFER TO PRODUCT SPECIFIC TECHNICAL DATA SHEET FOR AUTHORIZED SUBSTRATES.
2. SURFACE PROFILES MUST MEET ICRI CSP 3-4. IF CSP 5, REFER TO REINFORCED **PUMADEC** SYSTEM DETAILS. DO NOT INSTALL **PUMADEC** SYSTEM BEYOND PRIMED SURFACES.
3. BACK COAT FLEECE ON VERTICAL SURFACES WITH **PUMADEC** RESIN.
4. DEPTH OF GROWING MEDIA MAY VARY DEPENDING ON PROJECT SPECIFIC REQUIREMENTS.
5. DETAIL IS FOR REFERENCE ONLY. REFER TO DESIGN PROFESSIONAL TO VERIFY WIND UPLIFT REQUIREMENTS.
6. REFER TO THE **PUMADEC** SYSTEM GUIDE SPECIFICATION AND WATERPROOFING DETAILS FOR RECOMMENDED INSTALLATION PROCEDURES.



999 N. Pacific Coast Hwy, Suite 800
El Segundo, CA 90245
800-486-1278 • www.henry.com

MANUFACTURER GUIDE DETAILS ARE FOR REFERENCE ONLY. HENRY DOES NOT ASSUME RESPONSIBILITY FOR ERRORS OR DEVIATIONS IN DESIGN OR ENGINEERING. PROJECT SPECIFIC VERIFICATION IS RECOMMENDED PRIOR TO INSTALLATION.

VEGETATIVE ROOFING - PUMADEC SYSTEM

TERMINATION OPTIONS

**UNREINFORCED FIELD MEMBRANE (CSP 3-4)
VERTICAL TERMINATION OPTIONS**

SCALE: N.T.S.

06-01-2020

VR-PUMA-U6