

ROUND OR SQUARE TUBE PENETRATION
(ABRADED AND CLEANED)

OPTIONAL TOP COAT **HENRY DEQCOAT 50**

PAVER SYSTEM OR
GRAVEL BALLAST

PERFORATED EDGE RESTRAINT

GROWING MEDIA
(VEGETATION NOT
SHOWN FOR CLARITY)

FILTER FABRIC

OPTIONAL MOISTURE
RETENTION FABRIC

WATER RETENTION
AND DRAINAGE
COMPOSITE

INSULATION

OPTIONAL DRAINAGE
COMPOSITE

ROOT BARRIER

PUMADEC FLEX 30SL
(WHITE - 30 MILS)

PUMADEC FLEX 30SL
(GRAY - 50 MILS)

TARGET/FINGER FLASHING

PUMADEC FLEX 31MV (80 MILS)

REINFORCED WITH

PUMADEC N-FLEECE

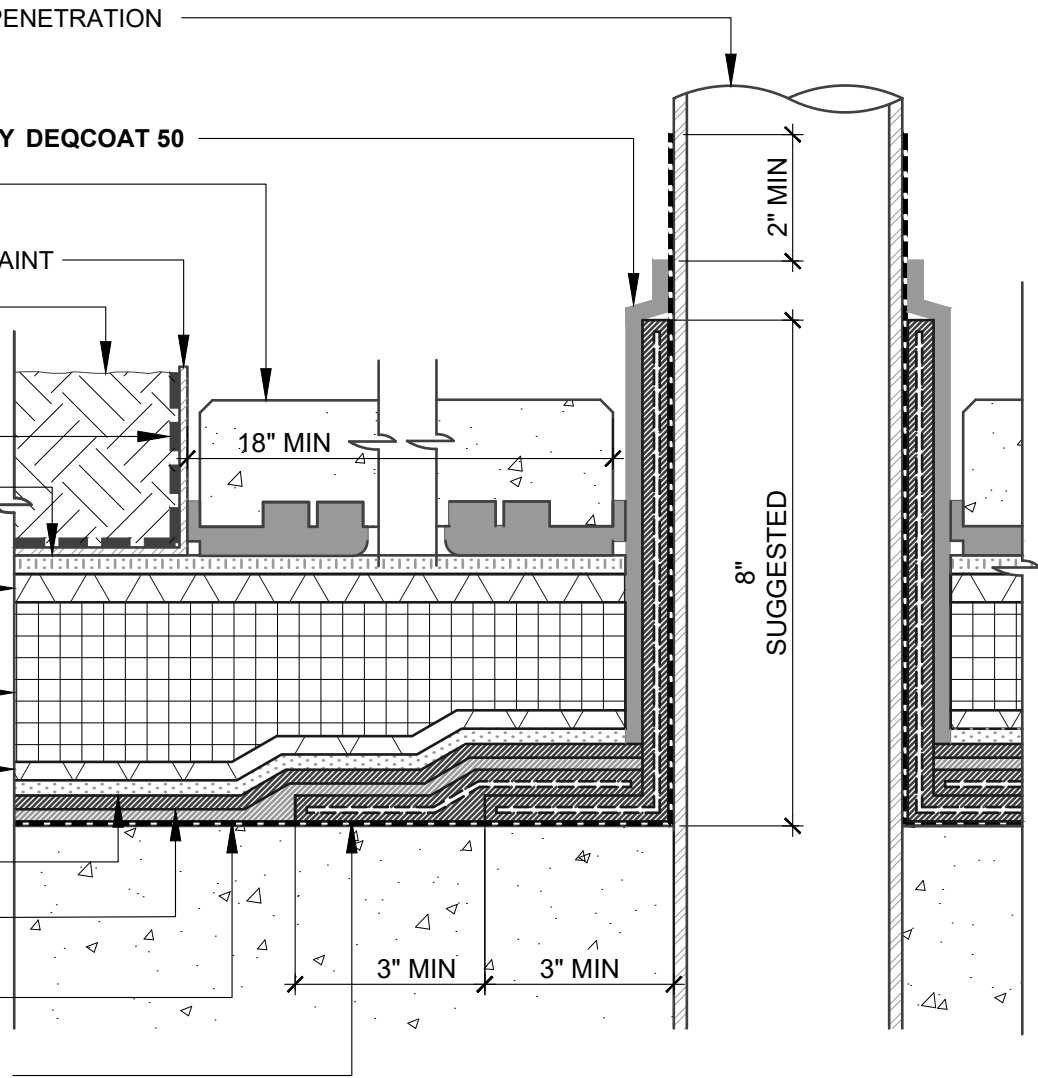

NOTES:

1. DETAIL SHOWS HENRY VEGETATIVE ROOFING WITH **PUMADEC** SYSTEM WATERPROOFING ASSEMBLY WITH AN UNREINFORCED FIELD MEMBRANE. SUBSTRATE SHOWN IS FOR REFERENCE ONLY. REFER TO PRODUCT SPECIFIC TECHNICAL DATA SHEET FOR AUTHORIZED SUBSTRATES.
2. SURFACE PROFILES MUST MEET ICRI CSP 3-4. IF CSP 5, REFER TO REINFORCED **PUMADEC** SYSTEM DETAILS.
3. DO NOT INSTALL **PUMADEC** SYSTEM BEYOND PRIMED SURFACES.
4. BACK COAT FLEECE ON VERTICAL SURFACES WITH **PUMADEC** RESIN.
5. FORM A COOL SLEEVE AROUND PIPES HOTTER THAN 150 °F.
6. DEPTH OF GROWING MEDIA MAY VARY DEPENDING ON PROJECT SPECIFIC REQUIREMENTS.
7. DETAIL IS FOR REFERENCE ONLY. REFER TO DESIGN PROFESSIONAL TO VERIFY WIND UPLIFT REQUIREMENTS.
8. REFER TO THE **PUMADEC** SYSTEM GUIDE SPECIFICATION AND WATERPROOFING DETAILS FOR RECOMMENDED INSTALLATION PROCEDURES.

Henry[®]

999 N. Pacific Coast Hwy, Suite 800
El Segundo, CA 90245
800-486-1278 • www.henry.com

MANUFACTURER GUIDE DETAILS ARE FOR REFERENCE ONLY. HENRY DOES NOT ASSUME RESPONSIBILITY FOR ERRORS OR DEVIATIONS IN DESIGN OR ENGINEERING. PROJECT SPECIFIC VERIFICATION IS RECOMMENDED PRIOR TO INSTALLATION.

VEGETATIVE ROOFING - PUMADEC SYSTEM

PIPE PENETRATION

**UNREINFORCED FIELD MEMBRANE (CSP 3-4)
PIPE PENETRATION ON A HORIZONTAL SUBSTRATE**

SCALE: N.T.S.

06-01-2020

VR-PUMA-U7A