



Foundation Waterproofing Systems

A comprehensive portfolio of pre-applied and post-applied foundation waterproofing systems

Water under pressure is relentless...

Whenever the water table rises, hydrostatic pressure increases and pushes water against a building's foundation from all directions. When the foundation is concrete, water will find a way in through cracks, voids, crevices and other imperfections, eventually reaching the interior as seepage or dampness. And the only thing standing in the way is the waterproofing system.

So is Henry waterproofing protection

Proven pre-applied and post-applied solutions

Backed by 50 years of waterproofing expertise, Henry Company foundation waterproofing systems are designed to withstand hydrostatic pressure. Each system features a membrane of exceptional durability, elasticity through freeze and thaw, and resistance to most naturally occurring and deposited chemicals and soil acidity.

For zero-property line applications, Henry offers a pre-applied solution featuring a unique dual bonding technology. For post applied applications, Henry offers multiple solutions based on project demands.

Part of a complete Building Envelope System

Unlike most waterproofing membranes that are standalone products, Henry foundation waterproofing systems are also a key part of the complete Henry Building Envelope Systems® portfolio which covers structures from foundation to roof. From drainage composites and waterstops to membranes, Henry foundation waterproofing systems integrate seamlessly with the Henry Building Envelope Systems portfolio.

Let Henry help you find the best foundation waterproofing system for your needs.

Henry® Blueskin PreSeal™ System

Combining mechanical and adhesive bond

The Henry **Blueskin PreSeal** membrane is a pre-applied, fully and permanently bonded sheet membrane system for waterproof construction. The unique dual bond of the **Blueskin PreSeal** membrane improves adhesion, reduces or eliminates lateral water migration as well as migration through the membrane, and reduces the sequencing delays associated with chemically bonded systems.

Installed prior to rebar installation and concrete placement, the **Blueskin PreSeal** membrane also features wide rolls resulting in fewer seams, reducing the risk of water ingress. On the jobsite, the system's lightweight rolls are easy to transport, cut and position, making installation fast and easy.

In partnership with  MAX FRANK

For more than half a century, Max Frank has been developing, producing and distributing proven products designed to waterproof concrete and reinforced concrete construction across Europe. Today, Henry Company is partnering with Max Frank to bring its proven pre-applied waterproofing technology to North America with Henry Blueskin PreSeal.

Features and benefits

-  Proprietary dual bond technology provides full mechanical and active, adhesive bond to the concrete
-  Dual bond helps accelerate scheduling by reducing sequencing delays tied to concrete cure time and form removal
-  Easily installs with self-adhering laps and splices – no special tools or torches required
-  Highly resistant to harmful substances in soil and groundwater, as well as superior resistance to water vapor and radon gas
-  Better cold weather performance than HDPE systems for excellent low temperature flexibility and crack bridging
-  Living Building Challenge Declare “Red List Free” status supports sustainable building properties

Blueskin PreSeal System Overview

- 1 Concrete
- 2 Blueskin PreSeal 320 or Blueskin PreSeal 435
- 3 Blueskin PreSeal Tape 120V*
- 4 Henry Drain Board
- 5 Henry 925 BES Sealant
- 6 Carlisle® MiraSTOP™ BW

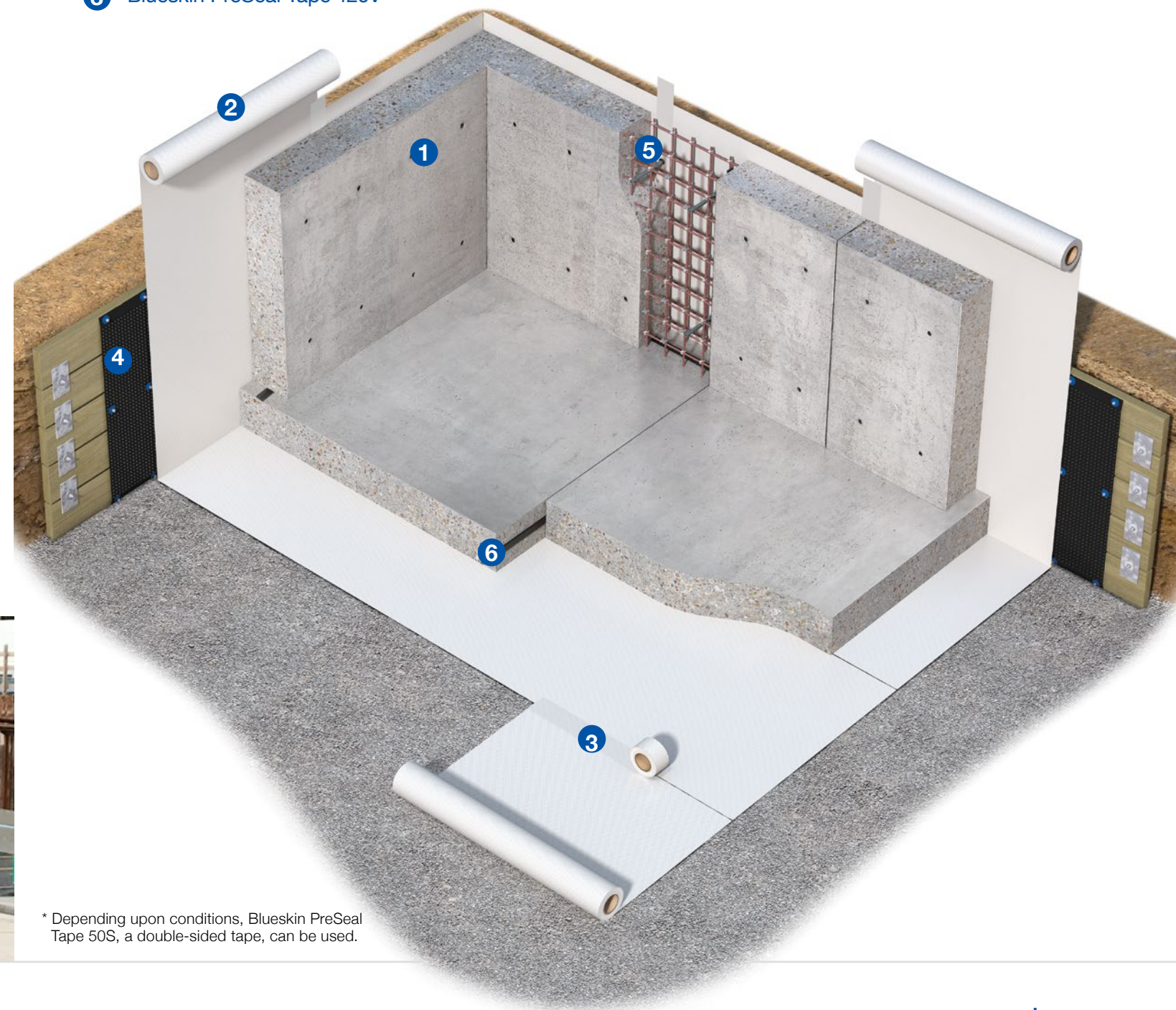

* Depending upon conditions, Blueskin PreSeal Tape 50S, a double-sided tape, can be used.

Henry Blueskin® WP200 Self-Adhered System

Easy to handle. Simple to apply.

The **Blueskin WP200** self-adhered waterproofing membrane provides a high-performance waterproofing barrier for post applied construction. **Blueskin WP200** fully adheres to the substrate and eliminates water migration between the membrane and the waterproofed surface.

Blueskin WP200 has excellent elongation properties for waterproofing coverage on a variety of substrates (concrete, masonry and wood) and can resist hydrostatic head pressures of up to 231 feet.

Features and benefits

-  Easy to install – no special equipment, heat or flame required
-  No curing time required – membrane can be backfilled immediately
-  Unique side-lap feature offers superior water-tightness
-  Flexible SBS rubberized asphalt membrane offers excellent cold weather application
-  No VOC and low odor

Blueskin WP200 System overview

- 1 Substrate/Concrete
- 2 Aquatac™ Primer or Blueskin LVC Primer
- 3 Blueskin WP200
- 4 Henry Drain Board
- 5 Henry 925 BES Sealant
- 6 Carlisle MiraSTOP BW

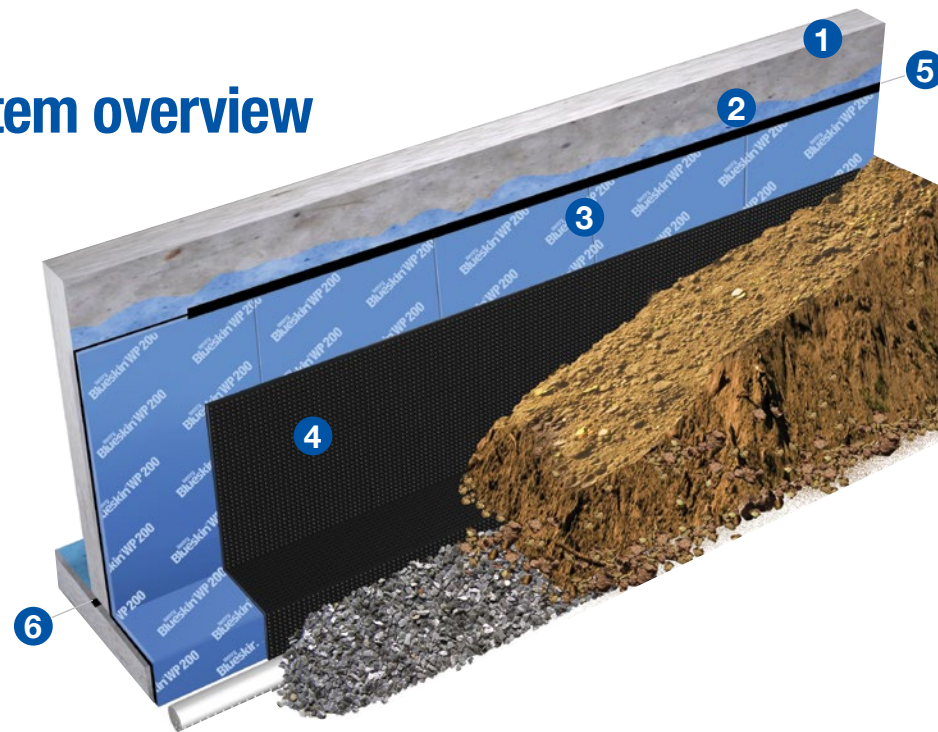



Henry Aqua-Bloc® Cold Fluid Applied System

Proven elastomeric performance

The **Aqua-Bloc System** elastomeric membranes are available in three formulations to meet a range of site-specific conditions.

Aqua-Bloc WB is a water-based, low-odor and low-VOC emulsified asphalt membrane that is ideal for waterproofing damp or green ICF (Insulated Concrete Forms). **Aqua-Bloc SB** is a solvent-based, single component membrane that is used to repair damaged rubberized membranes. **Aqua-Bloc QS** is a quick-setting, low-odor and low-VOC emulsified asphalt membrane that performs very well in cold temperatures.

Features and benefits

-  Seamless elastomeric membranes retain flexibility over a wide temperature range
-  Easy to install – no special equipment, heat or flame required
-  Excellent adhesion to a range of horizontal and vertical surfaces

Aqua-Bloc System overview

- 1 Substrate/Concrete
- 2 Aqua-Bloc WB, SB or QS
- 3 Henry Drain Board
- 4 Carlisle MiraSTOP BW







Henry CM100 Cold Fluid Applied System

**Apply it sooner.
Finish the job faster.**

Henry CM100 is a cold fluid-applied, single-component, elastomeric waterproofing membrane ideal for a variety of foundation applications. With **Henry CM100**, you no longer have to wait several days for concrete to dry before applying a waterproofing membrane. It cures by reacting with atmospheric and surface moisture to provide a seamless and impervious waterproofing membrane.

Features and benefits

-  Can be applied to green concrete 24 hours after forms are removed
-  Typical cure time* is three hours, allowing application of multiple coats in a single day
-  Solvent-free, low odor and non-flammable for safe installation in confined spaces
-  High solids content retains applied thickness with no shrinkage
-  Designed for vertical or horizontal applications, including difficult-to-access areas

Henry CM100 System overview

- 1** Concrete
- 2** Henry CM100
- 3** Henry Drain Board
- 4** Carlisle MiraSTOP BW



* Subject to weather conditions; see technical data sheet for more details

Foundation Waterproofing System Accessories

Carlisle MiraSTOP NBW

MiraSTOP NBW is a hydrophilic, rubber based, highly chemically resistant waterstop that swells when it comes in contact with water. **MiraSTOP NBW** is used in foundation slab and below grade wall applications, creating watertight joints.



NSF NSF 61 approved: will not leach or mix with potable water.

Carlisle MiraSTOP BW

MiraSTOP BW is an easy to use, preformed, self-adhesive hydrophilic waterstop that provides a watertight seal in cold joints on concrete structures. Designed to swell into surfaces upon contact with water, **MiraSTOP BW** stays flexible in cold weather and eliminates the need for split forming, wiring to rebar, or heat welding of splices.



Henry Drain Board: Improving waterproofing performance

As a key part of all Henry foundation waterproofing systems, **Henry Drain Board** is a cost-effective drainage composite that helps improve the flow of water away from the foundation.

Featuring a polystyrene or polypropylene core combined with a polypropylene fabric, **Henry Drain Board** is available in a range of compressive strength and flow rate options to meet every waterproofing application demand.



Total protection is our mission

Henry Building Envelope Systems

For over 80 years, Henry products and systems have helped manage the flow of water, air, vapor, and energy through the building envelope. From foundation to roof, our solutions improve the energy efficiency, livability and sustainability of commercial and residential structures, for the benefit of the owner, occupant and the environment.

Most importantly, our experience has confirmed that the building envelope needs to be viewed as a holistic system – from roof to wall to foundation – offering a solid line of defense from the elements. Today, our Building Envelope Systems include an entire portfolio of interrelated solutions to help you meet the challenges you face.

When it comes to making sure you get the **waterproofing systems** and **Building Envelope Systems** solutions and expertise you need,

Waterproofing Systems

Designing a durable waterproofing system starts with the foundation waterproofing system and extends to critical transition areas such as plaza decks. Once the building is complete, the opportunity to integrate an optimized waterproofing system into the building envelope is lost. Henry provides proven, comprehensive waterproofing solutions that keep the structure dry and protect it from damage due to water infiltration.

Air Barrier Systems

Designing air barrier systems for today's structures has never been more challenging. A designer has to balance air leakage, water resistance, vapor management, thermal controls and fire resistance, all while keeping an eye on the budget. Henry Building Envelope Systems include an entire portfolio of air barrier solutions to help you meet your goals.

Roofing Systems

From providing durable, watertight performance, to managing storm water run-off and offering outdoor green spaces, Henry roofing systems are designed to meet the challenges of these evolving trends. Inverted roof membrane assemblies, including vegetative roof assemblies and solutions for plaza decks, along with conventional roofing solutions for low-slope and flat roof applications help provide years of reliable service to building owners and occupants.

All Henry Building Envelope Systems are backed by comprehensive warranties.

Henry[®]

Building Envelope Systems[®]
Roofing | Air Barrier | Waterproofing

Ask us today about other Henry[®] solutions that help manage the flow of water, air, vapor and energy.

Henry, Aqua-Bloc, Blueskin, Blueskin PreSeal are registered trademarks of Henry Company. Carlisle is a registered trademark of Carlisle. Max Frank is a registered trademark of Max Frank GmbH & Co.